

TRENDnet®



Quick Installation Guide

TPE-TG82ES (V2)/TPE-TG182ES (V1)/TPE-TG262ES (V1)

Table of Contents

1 Português

1. Antes de Iniciar
2. Referência Rápida
3. Instalação de Hardware e Configuração
<https://www.trendnet.com/qig/1080>



1. Antes de Iniciar

Conteúdo da Embalagem

- TPE-TG82ES(V2)/TPE-TG182ES(V1)/TPE-TG262ES(V1)
- Guia de Instalação Rápida
- Power Brick TPE-TG82ES (55V DC, 1.3A)
- Cabo de alimentação

Requisitos de Sistema

- Um computador com uma porta Ethernet e navegador da Web
- Rede cabeada

2. Referência Rápida

Nota: O modelo de switch pode ser diferente do exemplo mostrado abaixo.

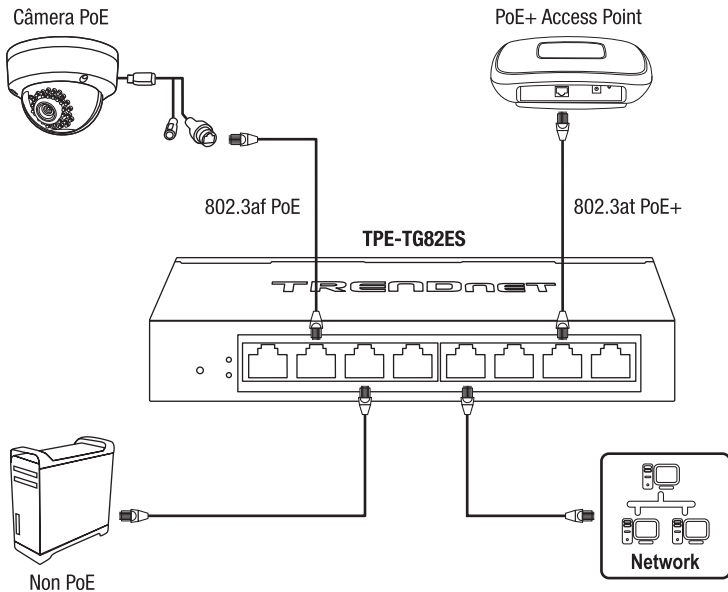

3. Instalação de Hardware e Configuração

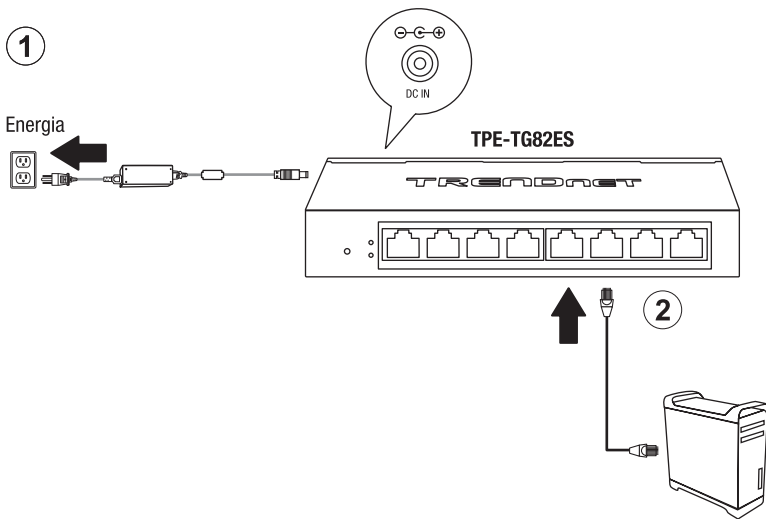

3. Colocar um endereço IP estático, na placa de rede do seu computador, na gama de Ips 192.168.10.x (por exemplo: 192.168.10.25) e colocar no campo da subnet mask 255.255.255.0.
4. Abra seu web browser, digite endereço IP do switch na barra de endereços e então pressione **Enter**. O endereço IP padrão é 192.168.10.200.

http://192.168.10.200

http://192.168.10.200

5. Entre com o **User Name** (Nome de Usuário) e **Password** (Senha) e então clique **LOGIN**.

Por padrão:

User Name(Nome de Usuário): **admin**

Password (Senha): **admin**

Nota: User Name (Nome do usuário) e Password (senha) são sensíveis a maiúsculas e minúsculas.

User Name: _____

Password: _____

LOGIN

6. Clique em **System** (Sistema) e depois clique em **IPv4 Setup** (Configuração IPv4).

7. Configure o switch para atender aos requisitos da sua rede. Em seguida, clique em **Apply** (Aplicar) para salvar as alterações.

Nota: Depois de clicar em Aplicar, você precisará fazer login novamente na página de gerenciamento do switch usando o novo endereço IP.

System

IPv4 Setup

System MAC Address: 00:23:79:00:23:79

System IP Address: 192 168 10 200

System Subnet Mask: 255 255 255 0

System Default Gateway: 0 0 0 0

System IP Mode: Static

DHCP Retry Time: (5 120)

Note: DHCP default retry interval: 5 seconds

Apply

8. Clicar em **OK**.

192.168.10.200 says

The management session will be disconnected. Use new IP address to connect to device.

OK Cancel

9. No painel do lado esquerdo, clique em **Save**.

10. Clicar em **Save Settings to Flash** (salvar Configurações para memória flash) (botão).

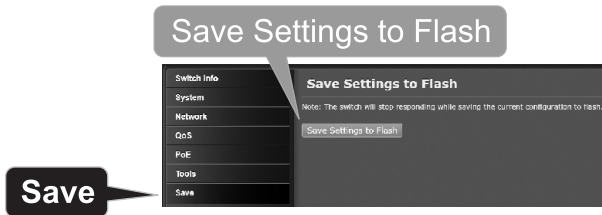

11. Clicar em **Continue**.



Para informações detalhadas sobre esta e outras configurações avançadas do **TPE-TG82ES/TPE-TG182ES/TPE-TG262ES**, por favor, consulte o Guia do Usuário na página de suporte da TRENDnet, www.trendnet.com/support.

TRENDNET[®]

Certifications

This device complies with Part 15 of the FCC Rules. Operation is subject to the following two conditions:

- (1) This device may not cause harmful interference.
- (2) This device must accept any interference received. Including interference that may cause undesired operation.



Waste electrical and electronic products must not be disposed of with household waste. Please recycle where facilities exist. Check with your Local Authority or Retailer for recycling advice.

Applies to PoE Products Only: This product is to be connected only to PoE networks without routing to the outside plant.

Note

The Manufacturer is not responsible for any radio or TV interference caused by unauthorized modifications to this equipment. Such modifications could void the user's authority to operate the equipment.

Advertencia

En todos nuestros equipos se mencionan claramente las características del adaptador de alimentación necesario para su funcionamiento. El uso de un adaptador distinto al mencionado puede producir daños físicos y/o daños al equipo conectado. El adaptador de alimentación debe operar con voltaje y frecuencia de la energía eléctrica domiciliar existente en el país o zona de instalación.

Technical Support

If you have any questions regarding the product installation, please contact our Technical Support. Toll free US/Canada: **1-866-845-3673**
Regional phone numbers available at www.trendnet.com/support

Product Warranty Registration

Please take a moment to register your product online. Go to TRENDnet's website at: www.trendnet.com/register

TRENDnet

20675 Manhattan Place
Torrance, CA 90501
USA

TPE-TG182ES:

Power Input Range: 100-240V AC, 50/60 Hz, 3.8A Max
Each PoE Output: 54Wdc, 500mA



This lightning flash with arrowhead symbol within an equilateral triangle, is intended to alert the user to the presence of non-insulated "dangerous voltage" within the product's enclosure that may be of sufficient magnitude to constitute a risk of electric shock.



The exclamation point within an equilateral triangle is intended to alert the user to the presence of important operating and maintenance (Servicing) instructions in the literature accompanying the appliance.

TPE-TG262ES:

Power Input Range: 100-240V AC, 50/60 Hz, 6.0A Max
Each PoE Output: 54Wdc, 500mA



WARNING: SHOCK HAZARD - DO NOT OPEN
AVIS: RISQUE DE CHOC ÉLECTRIQUE - NE PAS OUVRIR

Note: The appliance inlet is served as disconnect device, the socket-outlet shall be installed near the equipment and shall be easily accessible.
La prise électrique est utilisée comme dispositif de déconnexion et la prise doit être installée à proximité de l'appareil et être facilement accessible.

Please make sure this product earthed correctly to ensure safety and prevent electrical shock.

Pour éviter tout risque d'électrocution, l'équipement doit être correctement mis à la terre lors de l'installation. N'ignorez pas le rôle du fil de terre, sinon vous risqueriez de vous électrocuter.

The unit with Class I construction shall be connected to a mains socket-outlet with a protective earthing connection. Le dispositif d'une structure de premier niveau doit être connecté à la prise d'alimentation par mise à la terre protectrice.