

TRENDnet[®]



Quick Installation Guide

TPE-TG82ES (V2)/TPE-TG182ES (V1)/TPE-TG262ES (V1)

Table of Contents

1 Italiano

1. Prima di cominciare
2. Riferimento rapido
3. Installazione e configurazione Hardware

<https://www.trendnet.com/qig/1090>



1. Prima di cominciare

Contenuto della Confezione

- TPE-TG82ES(V2)/TPE-TG182ES(V1)/TPE-TG262ES(V1)
- Guida di Installazione Rapida
- Convertitore d'alimentazione TPE-TG82ES (55V DC, 1.3A)
- Cavo di alimentazione

Requisiti minimi

- Computer con porta Ethernet e Web browser
- Cavo di rete

2. Riferimento rapido

Nota: Il modello di switch (commutatore) potrebbe essere diverso da quello mostrato nell'esempio seguente.

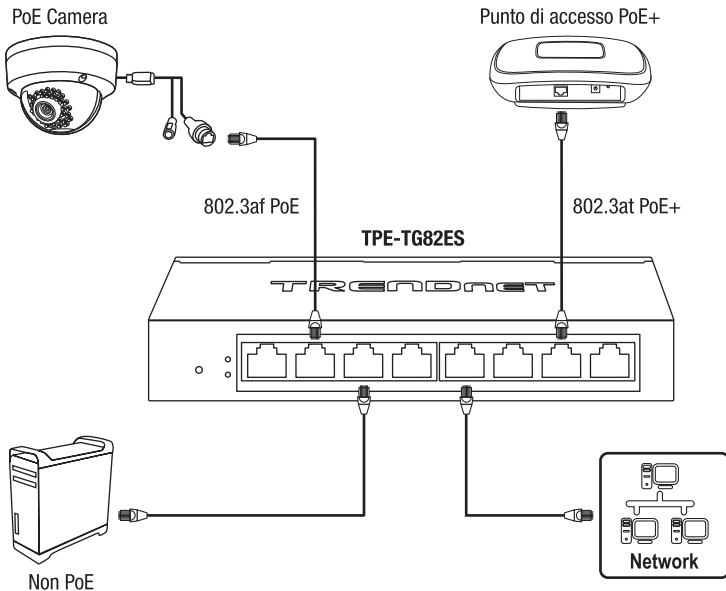

3. Installazione e configurazione Hardware

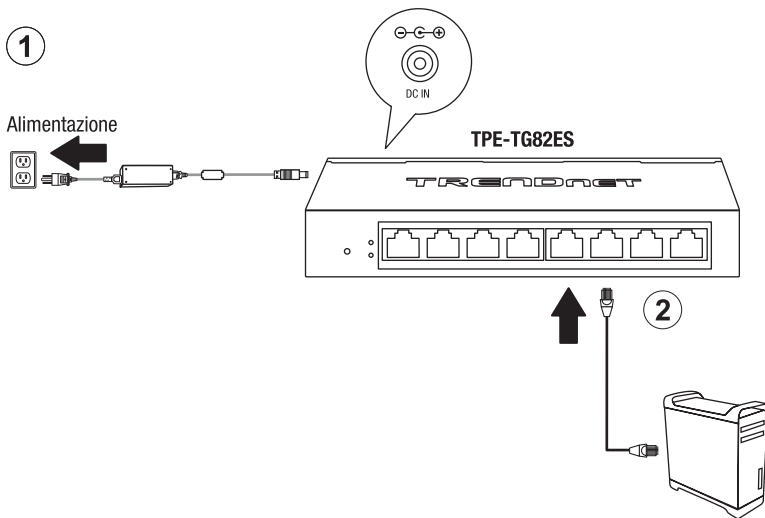

3. Assignare un indirizzo IP statico alla scheda di rete del proprio computer nella sottorete 192.168.10.x (e.g. 192.168.10.25) con subnet mask 255.255.255.0.
4. Aprire il web browser, digitare l'indirizzo IP dello switch nella barra indirizzi e premere **Invio**. L'indirizzo IP di fabbrica è 192.168.10.200.

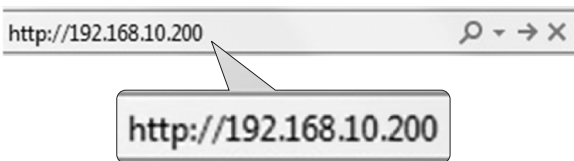

5. Inserire **User name** e **Password** e cliccare **LOGIN**. Preimpostazioni:

User Name: **admin**

Password: **admin**

Nota: User name e Password sono sensibili alle maiuscole/minuscole.

6. Cliccare **System** e poi cliccare **IPv4 Setup**.

7. Configurare lo switch secondo i requisiti richiesti dalla propria rete e poi cliccare **Apply**.

Nota: Dopo aver fatto clic su Applica, sarà necessario accedere nuovamente alla pagina di gestione dello switch utilizzando il nuovo indirizzo IP.

8. Cliccare **OK**.

9. Nel pannello di sinistra, clic su **Save** (Salva).

10. Cliccare **Save Settings to Flash** (tasto).

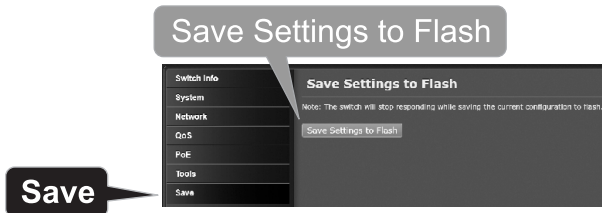

11. Cliccare **Continue**.

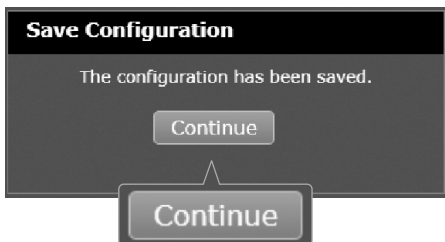

Per scaricare la versione più recente della guida utente, andare su:
<https://www.trendnet.com/support> e selezionare il **TPE-TG82ES/TPE-TG182ES/TPE-TG262ES** all'interno dell'elenco a discesa Download Prodotto.

TRENDNET[®]

Certifications

This device complies with Part 15 of the FCC Rules. Operation is subject to the following two conditions:

- (1) This device may not cause harmful interference.
- (2) This device must accept any interference received. Including interference that may cause undesired operation.



Waste electrical and electronic products must not be disposed of with household waste. Please recycle where facilities exist. Check with your Local Authority or Retailer for recycling advice.

Applies to PoE Products Only: This product is to be connected only to PoE networks without routing to the outside plant.

Note

The Manufacturer is not responsible for any radio or TV interference caused by unauthorized modifications to this equipment. Such modifications could void the user's authority to operate the equipment.

Advertencia

En todos nuestros equipos se mencionan claramente las características del adaptador de alimentación necesario para su funcionamiento. El uso de un adaptador distinto al mencionado puede producir daños físicos y/o daños al equipo conectado. El adaptador de alimentación debe operar con voltaje y frecuencia de la energía eléctrica domiciliar existente en el país o zona de instalación.

Technical Support

If you have any questions regarding the product installation, please contact our Technical Support. Toll free US/Canada: **1-866-845-3673**
Regional phone numbers available at www.trendnet.com/support

Product Warranty Registration

Please take a moment to register your product online. Go to TRENDnet's website at: www.trendnet.com/register

TRENDnet

20675 Manhattan Place
Torrance, CA 90501
USA

TPE-TG182ES:

Power Input Range: 100-240V AC, 50/60 Hz, 3.8A Max
Each PoE Output: 54Wdc, 500mA



This lightning flash with arrowhead symbol within an equilateral triangle, is intended to alert the user to the presence of non-insulated "dangerous voltage" within the product's enclosure that may be of sufficient magnitude to constitute a risk of electric shock.



The exclamation point within an equilateral triangle is intended to alert the user to the presence of important operating and maintenance (Servicing) instructions in the literature accompanying the appliance.

TPE-TG262ES:

Power Input Range: 100-240V AC, 50/60 Hz, 6.0A Max
Each PoE Output: 54Wdc, 500mA



WARNING: SHOCK HAZARD - DO NOT OPEN
AVIS: RISQUE DE CHOC ÉLECTRIQUE - NE PAS OUVRIR

Note: The appliance inlet is served as disconnect device, the socket-outlet shall be installed near the equipment and shall be easily accessible.
La prise électrique est utilisée comme dispositif de déconnexion et la prise doit être installée à proximité de l'appareil et être facilement accessible.

Please make sure this product earthed correctly to ensure safety and prevent electrical shock.

Pour éviter tout risque d'électrocution, l'équipement doit être correctement mis à la terre lors de l'installation. N'ignorez pas le rôle du fil de terre, sinon vous risqueriez de vous électrocuter.

The unit with Class I construction shall be connected to a mains socket-outlet with a protective earthing connection. Le dispositif d'une structure de premier niveau doit être connecté à la prise d'alimentation par mise à la terre protectrice.