

TRENDnet®



Quick Installation Guide Industrial Fiber Media Converters

Table of Contents

Please click on the language below to go to the selected language

1 English

1. Before You Start
2. Quick Reference
3. Hardware Installation
4. Additional information

8 Français

1. Avant de commencer
2. Références rapides
3. Installation du matériel
4. Informations supplémentaires

15 Deutsch

1. Bevor Sie Anfangen
2. Schnellübersicht
3. Installation du matériel
4. Weitere Informationen

22 Español

1. Antes de comenzar
2. Referencia rápida
3. Instalación del Hardware
4. Más información

29 Português

1. Antes de começar
2. Referência rápida
3. Instalação do hardware
4. Informação adicional

36 Italiano

1. Prima di cominciare
2. Riferimento rapido
3. Installazione hardware
4. Informazioni Aggiuntive

<https://www.trendnet.com/qig/1660>



Safety Note



- Turn off the power before connecting / disconnecting any module or wire. The correct power supply voltage (12 - 56 V DC/18 - 36 V AC/48-56V DC) is listed on the product label. Check the voltage of your power source to make sure that you are using the correct part. Do NOT use voltage greater than 12 - 56V DC/18 - 36VAC/48-56V DC, as specified on the product label.
- Calculate the maximum possible current in each power wire and common wire. Observe all electrical codes dictating the maximum current allowable for each wire size. If the current surpasses the maximum ratings, the wiring could overheat, causing serious damage to your equipment.

1. Before You Start

Package Contents

- TI-F11SFP/TI-F711SFP/TI-BF711SFP/TI-UF11SFP/TI-PF11SFP
- Quick Installation Guide
- Removable terminal block
- DIN-rail mount
- Wall mount plates

Minimum Requirements

- Existing network
- Power supply (TI-M6024/TI-S12048)

2. Quick Reference

Note: The Media Converter may be different than the one shown in the example.

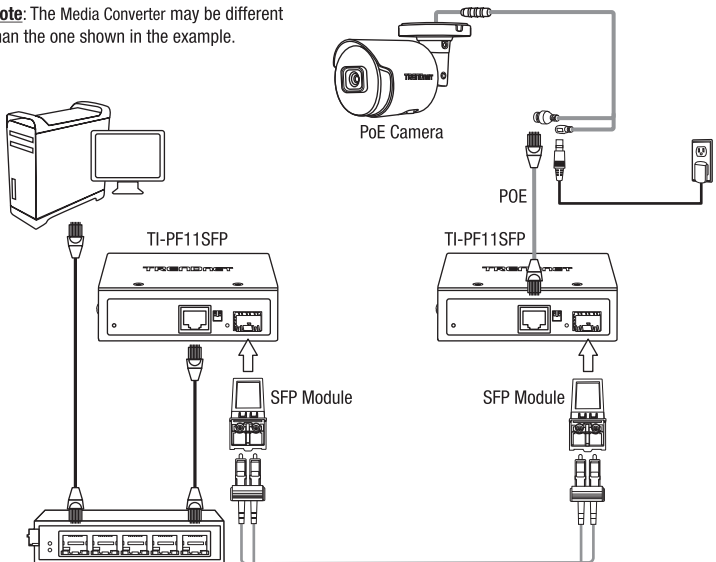

3. Hardware Installation

- The TI-F11SFP/TI-F711SFP/TI-BF711SFP/TI-UF11SFP/TI-PF11SFP can be placed on a desktop, wall, or mounted to a DIN-rail.

DIN-rail Mounting Instructions

1. Attach the DIN-rail mount bracket to the media converter.

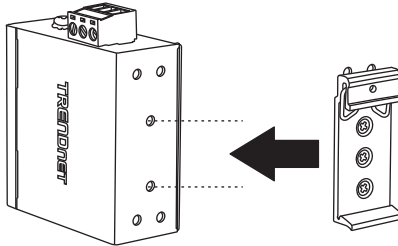

2. Position the unit in front of the DIN-rail and hook the mount over the top of the rail.
3. Rotate the media converter downward towards the rail to lock it into place. You will know it is secure when you hear the click.

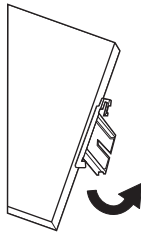

Mounting the unit

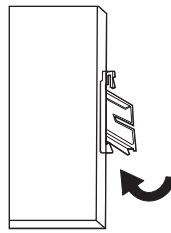

Releasing the unit

4. To remove the unit, pull down to clear the bottom of the DIN-rail and rotate away from the rail.

Wall Mounting Instructions

1. Attach the wall mount plates to the media converter.
2. Mount the unit.

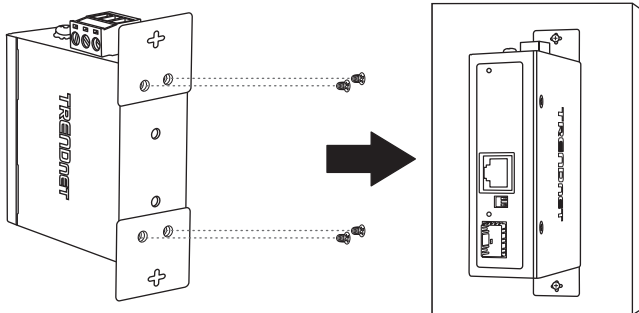

Applying Power

1. Connect the power supply (sold separately) to the included terminal block (as shown below) and secure the screws.

Note: Polarities must match.

2. Attach the terminal block to the unit, connect the neutral wire to the ground, and supply power to the power adapter.

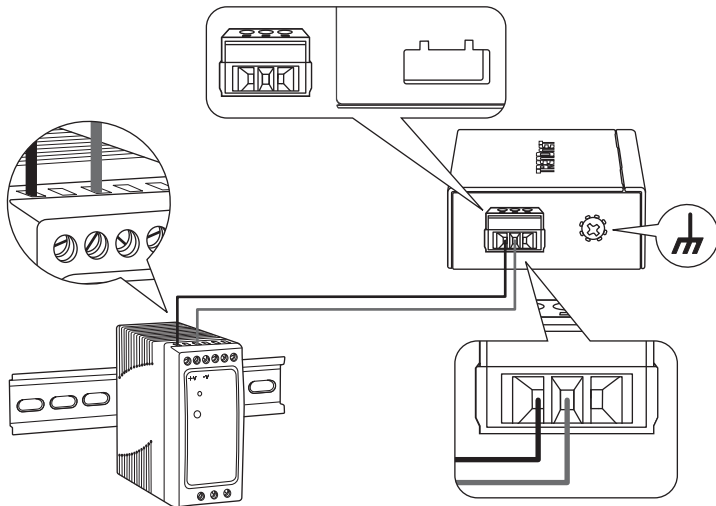

3. Connect your Ethernet cable, install an SFP module, and connect a fiber cable to the media converter. Check the LEDs to confirm the connections are established. Your installation is completed.

4. Additional information

DIP Switches

TI-F11SFP

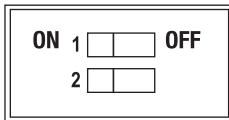

1: LFPT	On: Enable LFPT (Default)
	OFF: Disable LFPT
2: Mode	ON: Converter Mode (Default)
	OFF: Switch Mode

TI-F711SFP/TI-BF711SFP

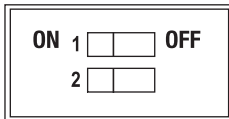

1: LFPT	On: Enable LFPT (Default)
	OFF: Disable LFPT
2: EEE (Energy Saving)	On: Enable EEE
	OFF: Disable EEE (Default)

LED Indicators

TI-F11SFP/TI-F711SFP

LED	Status	Description
PWR	Solid Green	Power is Detected
	Off	Power is not Detected
Ethernet Port	Solid Green	Connected at 10/100/1000Mbps
	Flashing Green	Data Transmitting / Receiving
	Off	No Connection
SFP Port	Solid Green	Connected at 1G
	Flashing Green	Data Transmitting / Receiving
	Off	No Connection

TI-BF711SFP

LED	Status	Description
PWR	Solid Green	Power is Detected
	Off	Power is not Detected
Ethernet Port	Solid Green	Connected at 10/100/1000Mbps
	Flashing Green	Data Transmitting / Receiving
	Off	No Connection
SFP Port	Solid Green	Connected at 1G
	Flashing Green	Data Transmitting / Receiving
	Off	No Connection
PoE+	Solid Green	PoE Connected
	Off	No PoE Connection

Consignes de sécurité



- Coupez le courant avant de brancher / débrancher quelque module ou câble que ce soit. La tension électrique correcte exacte (12 - 56 V DC/18 - 36 V AC ou 48-56V DC) est indiquée sur l'étiquette du produit. Vérifiez le voltage de votre source d'alimentation afin de vous assurer d'utiliser la pièce adéquate. N'utilisez PAS une tension supérieure à 12 - 56 V DC/18 - 36 V AC ou 48-56V DC, comme précisé sur l'étiquette du produit.
- Calculez le courant maximum possible sur chaque câble d'alimentation et sur les câbles communs. Respectez tous les codes électriques indiquant le courant maximum accepté par chaque taille de fil. Si le courant dépasse les indications maximales, le câblage pourrait surchauffer et provoquer des dégâts importants à votre matériel.

1. Avant de commencer

Contenu de l'emballage

- TI-F11SFP/TI-F711SFP/TI-BF711SFP/TI-UF11SFP/TI-PF11SFP
- Guide d'installation rapide
- Bornier détachable
- Fixation rail DIN
- Plaques pour fixation murale

Configuration minimale

- Réseau existant
- Alimentation électrique (TI-M6024/TI-S12048)

2. Références rapides

Remarque: Le convertisseur de média peut être différent de celui montré dans l'exemple.

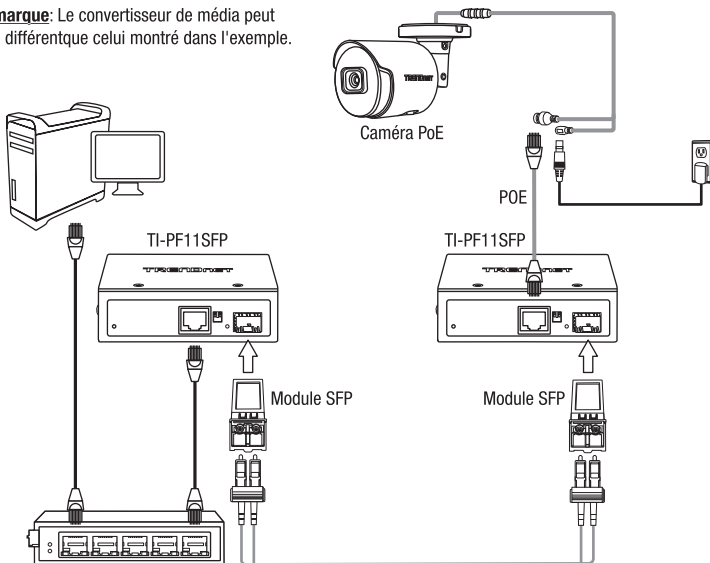

3. Installation du matériel

- Le TI-F11SFP/TI-F711SFP/TI-BF711SFP/TI-UF11SFP/TI-PF11SFP peut être placé sur un bureau, sur un mur ou fixé sur un rail DIN.

Instructions de fixation rail DIN

1. Fixez le support de fixation rail DIN au convertisseur média.

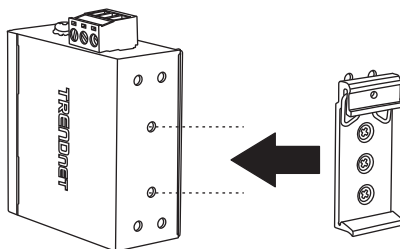

2. Installez l'appareil en face du rail DIN et accrochez le support de fixation au-dessus du rail.
3. Faites pivoter le convertisseur média vers le bas en direction du rail afin de le fixer à son emplacement. Un clic vous avertira lorsqu'il est en place.

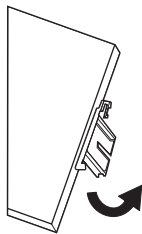

Installation de l'appareil

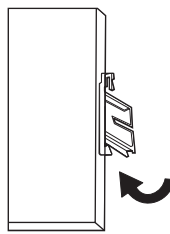

Retirer l'appareil

4. Pour enlever l'appareil, appuyez vers le bas afin de libérer le bas du rail DIN et faites-le pivoter hors du rail.

Instructions de fixation murale

1. Fixez les plaques de fixation murale au convertisseur média.
2. Installez l'appareil.

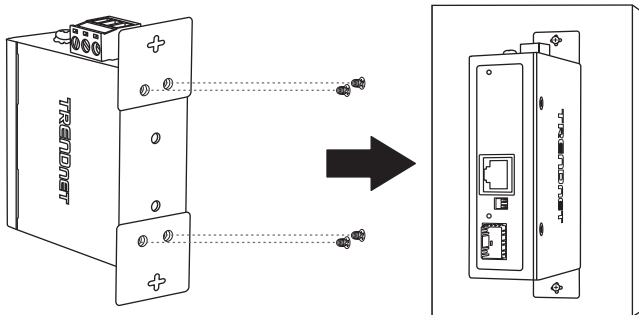

Mise sous tension

1. Connectez l'alimentation électrique (vendu séparément) au bornier fourni (comme illustré ci-dessous) et fixez-le à l'aide de vis.

Remarque: Respecter les polarités.

2. Attachez la borne d'alimentation à l'appareil, connectez le câble neutre au sol et alimentez l'adaptateur secteur.

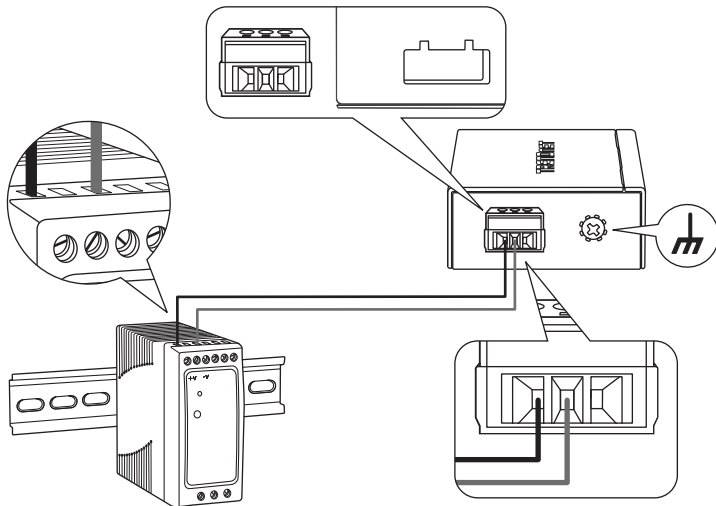

3. Connectez votre câble Ethernet, installez un module SFP et connectez un câble fibre au convertisseur de médias. Vérifiez les LED afin de confirmer que les connexions sont établies. Votre installation est terminée.

4. Informations supplémentaires

Interrupteur Dip

TI-F11SFP

ALLUMÉ 1 <input type="checkbox"/>	<input type="checkbox"/>	ÉTEINT
2 <input type="checkbox"/>	<input type="checkbox"/>	

1: LFPT	Allumé: Enable LFPT (par défaut)
	Éteint: Désactiver LFPT
2: Mode	Allumé: Mode Convertisseur (par défaut)
	Éteint: Mode Switch

TI-F711SFP/TI-BF711SFP

ALLUMÉ 1 <input type="checkbox"/>	<input type="checkbox"/>	ÉTEINT
2 <input type="checkbox"/>	<input type="checkbox"/>	

1: LFPT	Allumé: Activer LFPT (par défaut)
	Éteint: Désactiver LFPT
2: EEE (Économie d'énergie)	Allumé: Activer EEE
	Éteint: Désactiver EEE (par défaut)

Voyants lumineux

TI-F11SFP/TI-F711SFP

LED	Statut	Description
PWR	Vert fixe	L'alimentation est fournie
	Éteint	L'alimentation n'est pas détectée
Port Ethernet	Vert fixe	Connexion à 10/100/1000Mbps
	Vert Clignotant	Transmission/réception de données
	Éteint	Aucune connexion
Port SFP	Vert fixe	Connexion à 1Gb/s
	Vert Clignotant	Transmission/réception de données
	Éteint	Aucune liaison n'est établie

TI-BF711SFP

LED	Status	Description
PWR	Vert fixe	L'alimentation est fournie
	Éteint	L'alimentation n'est pas détectée
Port Ethernet	Vert fixe	Connexion à 10/100/1000Mbps
	Vert Clignotant	Transmission/réception de données
	Éteint	Aucune connexion
Port SFP	Vert fixe	Connexion à 1Gb/s
	Vert Clignotant	Transmission/réception de données
	Éteint	Aucune connexion
PoE+	Vert fixe	PoE connecté
	Éteint	Pas de connexion PoE

Sicherheitshinweis



- Stellen Sie den Strom ab, bevor Sie ein Modul oder Kabel anschließen//trennen. Die richtige Stromversorgungsspannung (12 - 56 V DC/18 - 36 V AC oder 48-56V DC) ist auf dem Etikett des Produkts angegeben. Überprüfen Sie die Spannung Ihrer Stromquelle, um sicherzustellen, dass Sie den richtigen Teil verwenden. Verwenden Sie KEINE Spannung, die größer als 12 - 56 V DC / 18 - 36VAC oder 48-56VDC (siehe Etikett) ist.
- Berechnen Sie die maximal möglichen Stromstärke jedes Stromdrahtes und des gemeinsamen Drahtes. Beachten Sie alle Stromvorschriften, die eine maximale Stromstärke für jede Drahtgröße angeben. Wenn die Stromstärke die maximalen Angaben überschreitet, kann sich der Draht überhitzen und Ihr Gerät schwer beschädigen.

1. Bevor Sie Anfangen

Paketinhalte

- TI-F11SFP/TI-F711SFP/TI-BF711SFP/TI-UF11SFP/TI-PF11SFP
- Kurzanleitung zur Installation
- Abnehmbare Anschlussleiste
- DIN-Schienenmontage
- Wandmontageplatten

Mindestanforderungen

- Bestehendes Netzwerk
- Stromversorgung (TI-M6024/TI-S12048)

2. Schnellübersicht

Hinweis: Der Medienkonverter kann anders sein als die im Beispiel gezeigte.

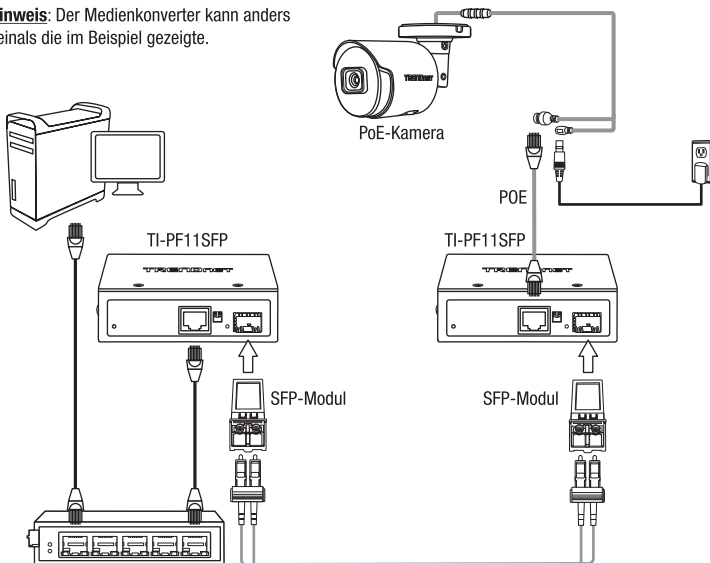

3. Hardware-Installation

- Der TI-F11SFP/TI-F711SFP/TI-BF711SFP/TI-UF11SFP/TI-PF11SFP kann auf dem Desktop, an der Wand oder auf einer DIN-Schiene installiert werden.

Anleitung zur DIN-Schienenmontage

1. Befestigen Sie die DIN-Schienenmontageklammer am Medienkonverter.

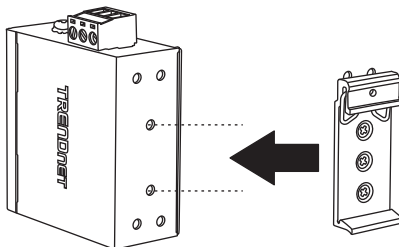

2. Positionieren Sie den gerät vor der DIN-Schiene und haken Sie die Montageklammer über dem oberen Teil der Schiene.
3. Drehen Sie den Medienkonverter nach unten in Richtung der Schiene, um diese in die richtige Position zu bringen. Sie werden feststellen, dass sie gesichert ist, wenn Sie das Klicken hören.

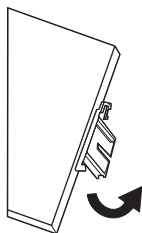

Montage des Gerät

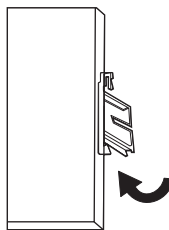

Freigabe des gerät

4. Um den gerät zu entfernen, ziehen nach unten, um das Ende der DIN-Schiene freizumachen, und von der Schiene wegdrehen.

Anweisungen zur Wandmontage

1. Befestigen Sie die Wandbefestigungsplatten am Medienkonverter.
2. Montieren Sie den Gerät.

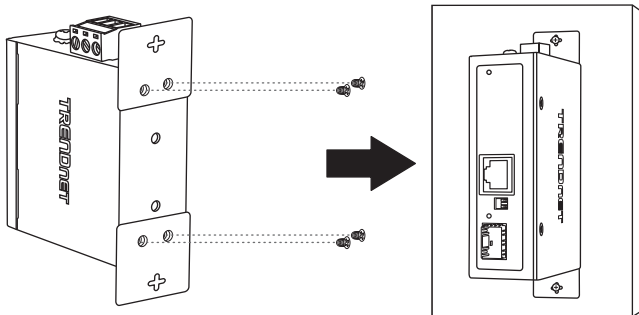

Stromanschluss

1. Befestigen Sie den Stromversorgung (getrennt erhältlich) an dem inbegriffenen Anschlussleiste (wie unten gezeigt), und sichern Sie ihn mit den Schrauben.

Hinweis: Die Polaritäten müssen passen.

2. Schließen Sie den Anschlussblock an das Gerät an, bringen Sie den Nullleiter in Kontakt mit dem Boden und versorgen Sie den Netzadapter mit Strom.

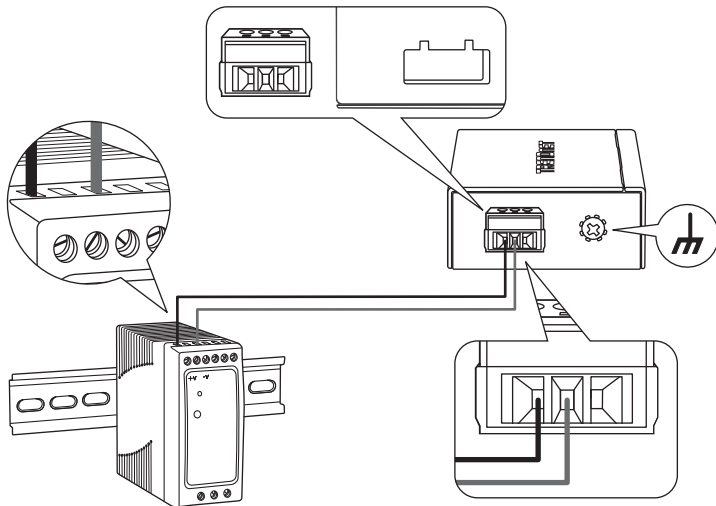

3. Schließen Sie Ihr Ethernet-Kabel an, installieren Sie ein SFP-Modul und verbinden Sie ein Glasfaserkabel mit dem Media-Konverter. Prüfen Sie die LED-Leuchten um sicherzustellen, dass die Verbindungen hergestellt wurden. Der Installationsvorgang ist damit abgeschlossen.

4. Weitere Informationen

Kippschalter

TI-F11SFP

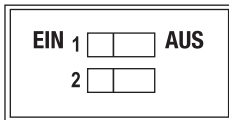

1: LFPT	Ein: LFPT aktivieren (Standard)
	Aus: LFPT deaktivieren
2: Mode	Ein: Coverter-Modus (Standard)
	Aus: Switch-Modus

TI-F711SFP/TI-BF711SFP

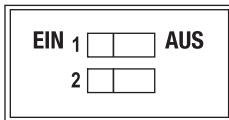

1: LFPT	Ein: LFPT aktivieren (Standard)
	Aus: LFPT deaktivieren
2: EEE (Energiesparen)	Ein: EEE aktivieren
	Aus: EEE deaktivieren (Standard)

LED-Anzeigen

TI-F11SFP/TI-F711SFP

LED	Status	Beschreibung
PWR	Solides Grün	Strom wird bereitgestellt
	Aus	Es wird kein Strom bereitgestellt
Ethernet Port	Solides Grün	Verbunden mit 10/100/1000 Mbit/s
	Blinkt grün	Datenübertragung/-empfang
	Aus	Keine Verbindung
SFP Port	Solides Grün	Verbindung mit 1 Gbps
	Blinkt grün	Datenübertragung/-empfang
	Aus	Keine Verbindung

TI-BF711SFP

LED	Status	Beschreibung
PWR	Solides Grün	Strom wird bereitgestellt
	Aus	Es wird kein Strom bereitgestellt
Ethernet-Port	Solides Grün	Verbunden mit 10/100/1000 Mbit/s
	Blinkt grün	Datenübertragung/-empfang
	Aus	Keine Verbindung
SFP-Port	Solides Grün	Verbindung mit 1 Gbps
	Blinkt grün	Datenübertragung/-empfang
	Aus	Keine Verbindung
PoE+	Solides Grün	PoE verbunden
	Aus	Keine PoE-Verbindung

Nota de seguridad



- Apague la alimentación antes de conectar / desconectar cualquier módulo o cable. El voltaje correcto de suministro de alimentación (12 - 56 V DC/18 - 36 V AC o 48-56V DC) figura en la etiqueta del producto. Compruebe el voltaje de su fuente de alimentación para asegurarse de que esté utilizando la parte correcta. NO utilice un voltaje superior a (12 - 56 V DC/18 - 36 V AC o 48-56V DC), según se especifique en la etiqueta del producto.
- Calcule la corriente máxima posible en cada cable de alimentación y cable común. Observe todos los códigos eléctricos que dictan la corriente máxima permisible para cada tamaño de cable. Si la corriente supera las calificaciones máximas, el cableado podría sobrecalentarse y producir daños graves en su equipo.

1. Antes de comenzar

Contenidos del Paquete

- TI-F11SFP/TI-F711SFP/TI-BF711SFP/TI-UF11SFP/TI-PF11SFP
- Guía de instalación rápida
- Bloque de terminales extraíble
- Montaje en DIN-rail
- Placas para montaje en pared

Requisitos mínimos

- Red existente
- Fuente de alimentación (TI-M6024/TI-S12048)

2. Referencia rápida

Nota: el convertidor de medios puede ser diferente que el que se muestra en el ejemplo.

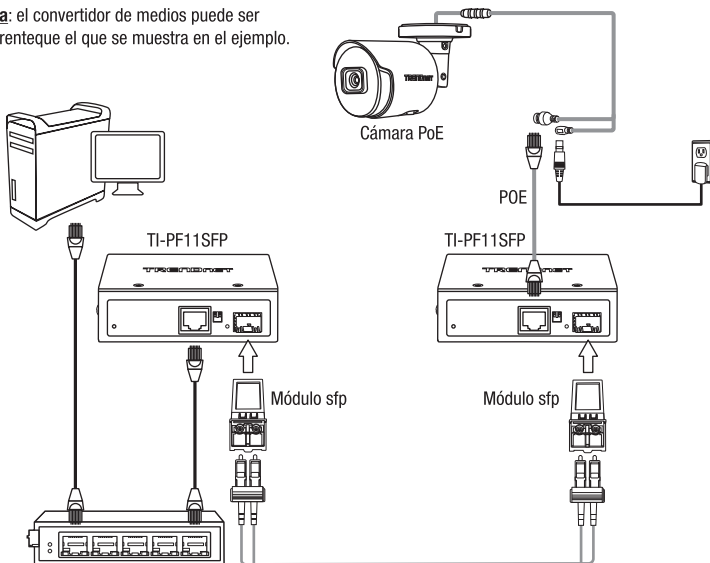

3. Instalación del hardware

- El TI-F11SFP/TI-F711SFP/TI-BF711SFP/TI-UF11SFP/TI-PF11SFP puede colocarse en un escritorio o montarse en una pared o en DIN-rail.

Instrucciones de montaje en DIN-rail

1. Acople el soporte de montaje DIN-rail al convertidor de medios.

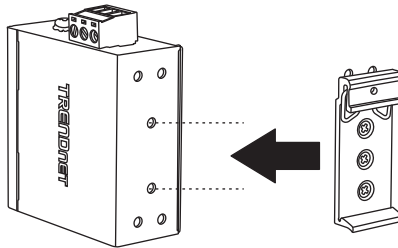

2. Coloque la unidad en frente del DIN-rail y enganche el soporte de montaje en el carril.
3. Gire el convertidor de medios para abajo hacia el carril hasta dejarlo bloqueado. Escuchará un clic cuando quede bloqueado.

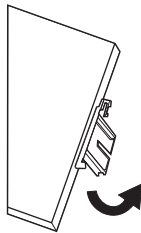

Montando la unidad

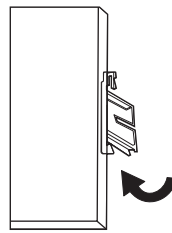

Soltando la unidad

4. Para retirar la unidad, presione hacia abajo para liberar la parte inferior del DIN-rail y gírelo hasta sacarlo del carril.

Instrucciones para montaje en pared

1. Fije las placas de montaje en pared al convertidor de medio.
2. Monte la unidad.

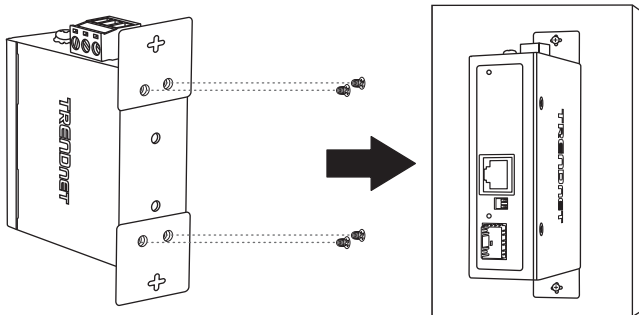

Aplicar la alimentación

1. Conecte el fuente de alimentación (se vende por separado) al bloque de terminales incluido (según se indica más abajo) y fjelo con los tornillos.

Nota: Las polaridades deben coincidir.

2. Acople el bloque terminal a la unidad, conecte el cable neutro a tierra y suministre alimentación al adaptador de corriente.

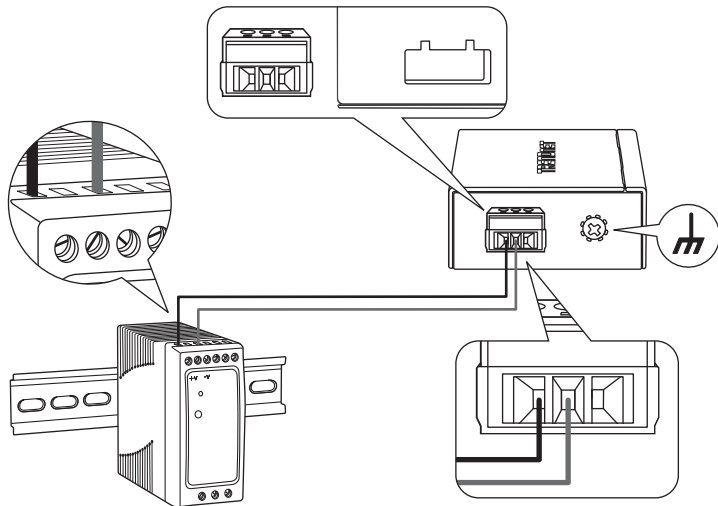

3. Conecte su cable Ethernet, instale un módulo SFP y conecte un cable de fibra al convertidor de medios. Compruebe los LED para confirmar que las conexiones estén establecidas. Su instalación ha finalizado.

4. Más información

Interruptores DIP

TI-F11SFP

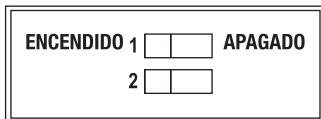

1: LFPT	Encendido: Habilitar LFPT (predeterminado)
	Apagado: Deshabilitar LFPT
2: Mode	Encendido: Modo de conversión (predeterminado)
	Apagado: Modo de conmutación

TI-F711SFP/TI-BF711SFP

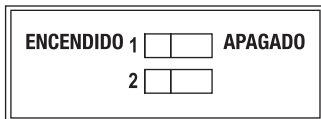

1: LFPT	Encendido: Habilitar LFPT (predeterminado)
	Apagado: Deshabilitar LFPT
2: EEE (Ahorro De Energía)	Encendido: Enable EEE
	Apagado: Deshabilitar EEE (predeterminado)

Indicadores LED

TI-F11SFP/TI-F711SFP

LED	Status	Descripción
PWR	Verde Solido	Se suministra energía
	Apagado	No se suministra energía
Puerto Ethernet	Verde Solido	Conectado a 10/100/1000Mbps
	Verde parpadeante	Transmisión/recepción de datos
	Apagado	Sin conexión
Puerto SFP	Verde Solido	Conectado a 1G
	Verde parpadeante	Transmisión/recepción de datos
	Apagado	Sin conexión

TI-BF711SFP

LED	Estado	Descripción
PWR	Verde Solido	Se suministra energía
	Apagado	No se suministra energía
Puerto Ethernet	Verde Solido	Conectado a 10/100/1000Mbps
	Verde parpadeante	Transmisión/recepción de datos
	Apagado	Sin conexión
Puerto SFP	Verde Solido	Conectado a 1G
	Verde parpadeante	Transmisión/recepción de datos
	Apagado	Sin conexión
PoE+	Verde Solido	PoE conectado
	Apagado	Sin conexión PoE

Nota de segurança



- Desligue a energia antes de conectar / desconectar qualquer módulo ou fio. A tensão correta da fonte de alimentação (12 - 56 V DC/18 - 36 V AC ou 48-56V DC) está indicada na etiqueta do produto. Verifique a tensão de sua fonte de energia para certificar-se de que está usando a peça correta. NÃO use uma tensão maior do que 12 - 56 V DC / 18 - 36 V AC ou 48-56V DC conforme especificado na etiqueta do produto.
- Calculate the maximum possible current in each power wire and common wire. Observe all electrical codes dictating the maximum current allowable for each wire size. If the current surpasses the maximum ratings, the wiring could overheat, causing serious damage to your equipment.

1. Antes de Começar

Conteúdo da Embalagem

- TI-F11SFP/TI-F711SFP/TI-BF711SFP/TI-UF11SFP/TI-PF11SFP
- Guia de instalação rápida
- Bloco de terminais removível
- Montagem em trilho DIN
- Placas de montagem na parede

Requisitos mínimos

- Rede existente
- Fonte de alimentação (TI-M6024/TI-S12048)

2. Consulta rápida

Nota: O conversor de mídia pode ser diferenciado que o mostrado no exemplo.

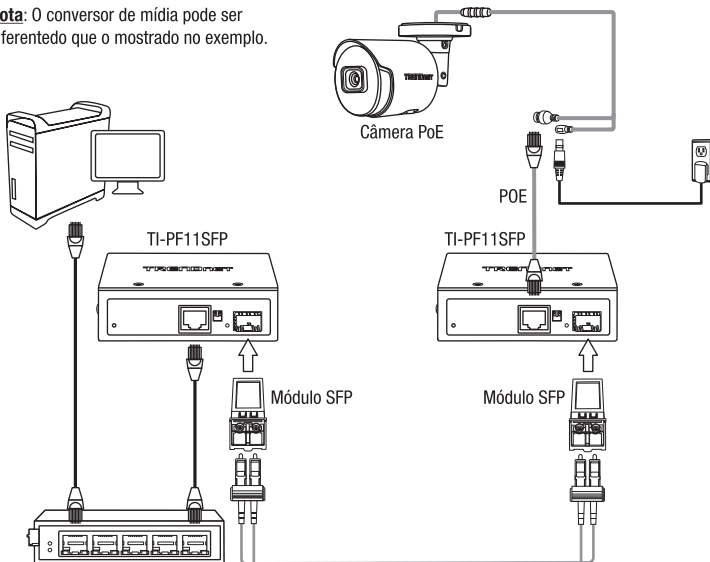

3. Instalação de Hardware

- O TI-F11SFP/TI-F711SFP/TI-BF711SFP/TI-UF11SFP/TI-PF11SFP pode ser colocado sobre uma mesa, parede ou montado em um trilho DIN.

Instruções de montagem em trilho DIN

1. Fixe o suporte de montagem em trilho DIN no conversor de mídia.

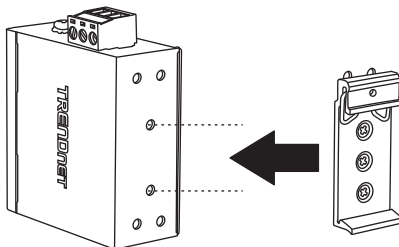

2. Posicione o unidade na frente do trilho DIN e enganche o suporte de montagem na parte superior do trilho.
3. Gire o conversor de mídia para baixo na direção do trilho para travá-lo no local adequado. Você saberá que ele está seguro quando ouvir um clique.

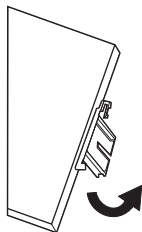

Montagem do unidade

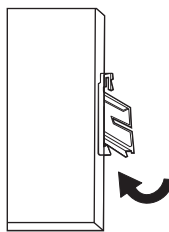

Liberação do unidade

4. Para remover o unidade, pressione para baixo para afastar a parte inferior do trilho DIN e gire, afastando-o do trilho.

Instruções de montagem na parede

1. Fixe as placas de montagem na parede no conversor de mídia.
2. Monte o unidade.

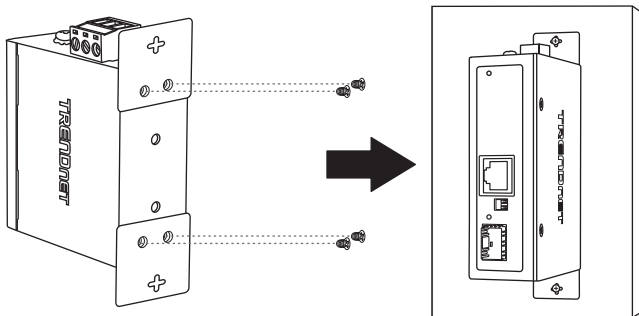

Aplicação de energia

1. Conecte o fonte de alimentação (vendido separadamente) ao bloco de terminais incluído (como exibido abaixo) e fixe com parafusos.

Nota: As polaridades devem coincidir.

2. Fixe o bloco de terminais na unidade, conecte o fio neutro ao aterramento e a fonte de alimentação ao adaptador de energia.

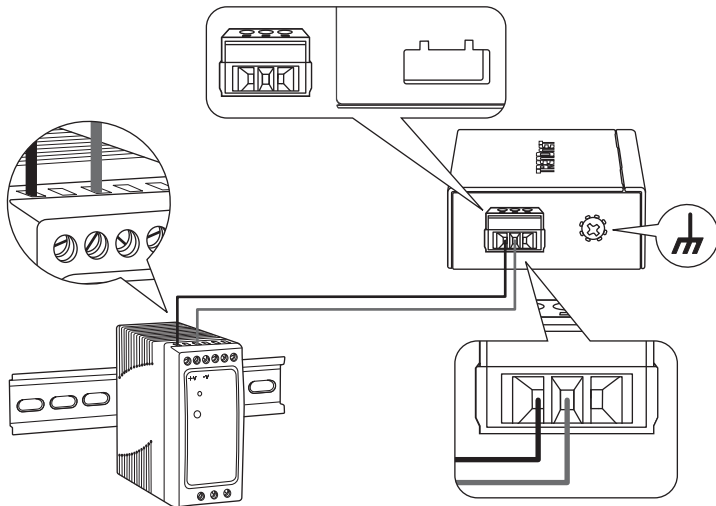

3. Conecte seu cabo Ethernet, instale um módulo SFP e conecte um cabo de fibra ao conversor de mídia. Verifique os LEDs para confirmar se as conexões estão estabelecidas. Sua instalação está concluída.

4. Informação adicional

Interruptor DIP

TI-F11SFP

LIGADO 1 <input type="checkbox"/>	DESLEGADO
2 <input type="checkbox"/>	

1: LFPT	LIGADO: Habilitar LFPT (Padrão)
	DESLEGADO: Desabilitar LFPT
2: Modo	LIGADO: Modo Coverter (Padrão)
	DESLEGADO: Modo Switch

TI-F711SFP/TI-BF711SFP

LIGADO 1 <input type="checkbox"/>	DESLEGADO
2 <input type="checkbox"/>	

1: LFPT	LIGADO: Habilitar LFPT (Padrão)
	DESLEGADO: Desabilitar LFPT
2: EEE (Economia de Energia)	LIGADO: Habilitar EEE
	DESLEGADO: Desabilitar EEE(Padrão)

Indicadores LED

TI-F11SFP/TI-F711SFP

Liderado	Status	Descrição
PWR	Verde Sólido	Energia fornecida
	Desligado	Não há energia
Porta Ethernet	Verde Sólido	Conectado a 10/100/1000Mbps
	Verde Piscando	Transmissão/Recepção de Dados
	Desligado	Nenhum link foi estabelecido
Porta SFP	Verde Sólido	Conexão estabelecida a 1Gbps
	Verde Piscando	Transmissão/Recepção de Dados
	Desligado	Nenhum link foi estabelecido

TI-BF711SFP

Liderado	Status	Descrição
PWR	Verde Sólido	Energia fornecida
	Desligado	Não há energia
Porta Ethernet	Verde Sólido	Conectado a 10/100/1000Mbps
	Verde Piscando	Transmissão/Recepção de Dados
	Desligado	Nenhum link foi estabelecido
Porta SFP	Verde Sólido	Conexão estabelecida a 1Gbps
	Verde Piscando	Transmissão/Recepção de Dados
	Desligado	Nenhum link foi estabelecido
PoE+	Verde Sólido	PoE conectado
	Desligado	Sem conexão PoE

Nota di sicurezza



- Spegnere l'alimentazione prima di collegare / scollegare qualsiasi modulo o filo. La corretta tensione di alimentazione (12 - 56 V DC/18 - 36 V AC o 48-56V DC) è elencata sull'etichetta del prodotto. Controllare il voltaggio della propria fonte di alimentazione per accertarsi di stare usando la parte corretta. Non utilizzare un voltaggio superiore a 12 - 56 V DC/18 - 36 V AC o 48-56V DC, come specificato sull'etichetta del prodotto.
- Calcolare la massima corrente possibile in ciascun cavo di alimentazione e cavo comune. Osservare tutti i codici elettrici che raccomandano la corrente massima disponibile per ciascuna dimensione del filo. Se la corrente supera la tensione nominale massima, il cablaggio potrebbe surriscaldarsi, causando seri danni alla vostra apparecchiatura.

1. Prima di cominciare

Contenuto della Confezione

- TI-F11SFP/TI-F711SFP/TI-BF711SFP/TI-UF11SFP/TI-PF11SFP
- Guida di Installazione Rapida
- Blocco contatti estraibile
- Montaggio su guida DIN
- Piastra di montaggio a parete

Requisiti minimi

- Rete esistente
- Alimentatore (TI-M6024/TI-S12048)

2. Riferimento rapido

Nota: il convertitore multimediale potrebbe essere diversorispetto a quello mostrato nell'esempio.

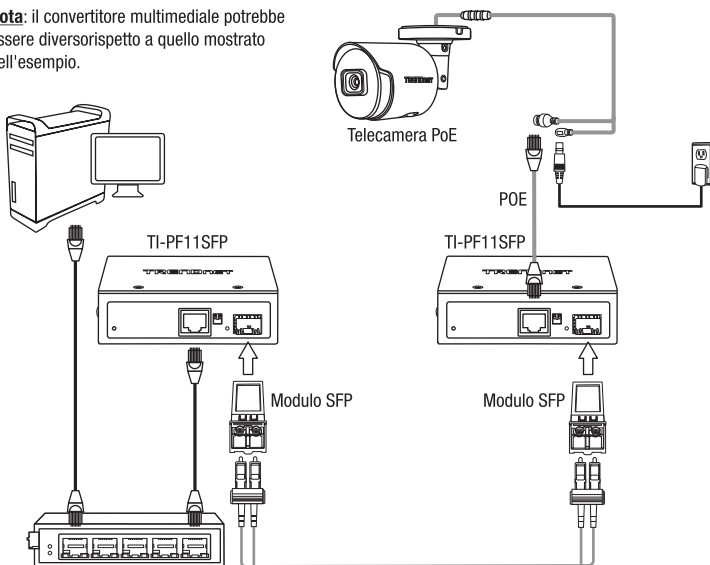

3. Installazione Hardware

- Il TI-F11SFP/TI-F711SFP/TI-BF711SFP/TI-UF11SFP/TI-PF11SFP può essere posizionato su tavolo, a muro oppure montato su guida DIN.

Istruzioni per il montaggio su guida DIN

1. Montare la staffa DIN sullo convertitore.

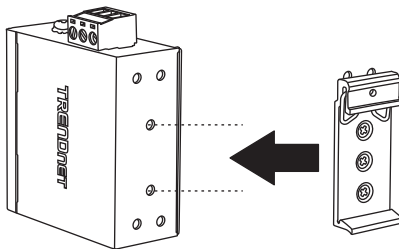

2. Posizionare l'unità di fronte al DIN-Rail e agganciare la staffa di montaggio sopra la parte superiore del binario.
3. Ruotare il router verso il basso verso la guida per bloccarlo in posizione.

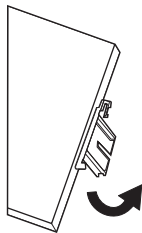

Installazione dell'unità

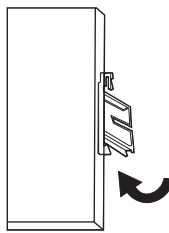

Disinstallazione dell'unità

4. Per rimuovere l'unità, spingere per liberare la parte inferiore del DIN-Rail e ruotare per allontanare dal binario.

Istruzione per il montaggio a muro

1. Fissare allo switch la piastra di montaggio a parete.
2. Installare lo switch.

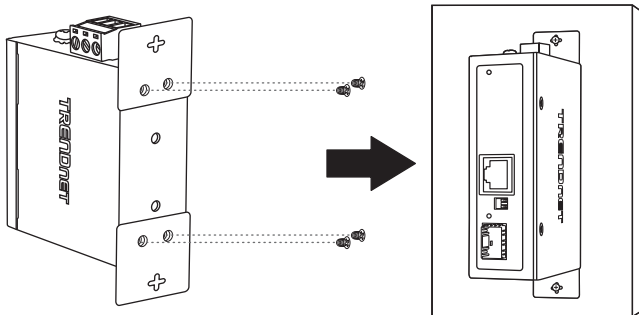

ENGLISH

FRANÇAIS

DEUTSCH

ESPAÑOL

PORTUGUÊS

ITALIANO

Collegare l'alimentazione

1. Collegare l'alimentatore (venduto a parte) al blocco contatti in dotazione (come mostrato in basso) e stringere le viti.

Nota: Rispettare le polarità.

2. Inserire il blocco contatti sull'unità, collegare il filo di terra e fornire corrente all'alimentatore.

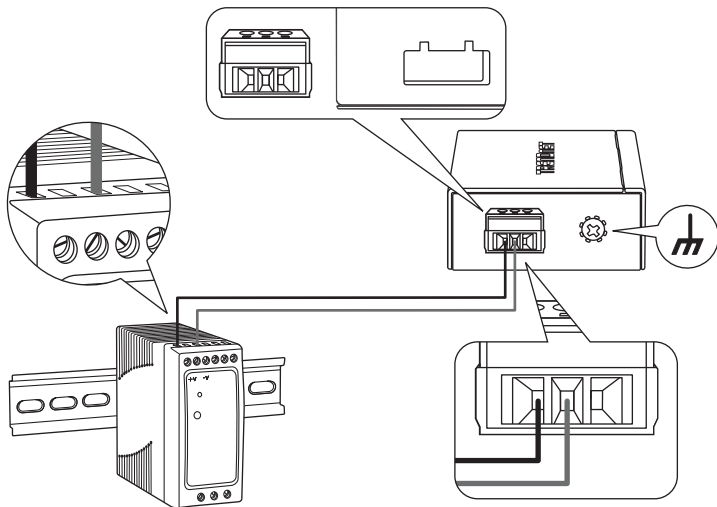

3. Collegare il cavo Ethernet, installare un modulo SFP e collegare un cavo in fibra al convertitore. Controllare i LED per verificare che le connessioni siano stabilite. La vostra installazione è completa.

4. Informazioni Aggiuntive

Interruttore Dip

TI-F11SFP

ACCENDERE	1	<input type="checkbox"/>	<input type="checkbox"/>	SPENTO
	2	<input type="checkbox"/>	<input type="checkbox"/>	

1: LFPT	ACCENDERE: Abilita LFPT (Default)
	SPENTO: Disabilita LFPT
2: Mode	ACCENDERE: Modalità Converter (Default)
	SPENTO: Modulo SFP

TI-F711SFP/TI-BF711SFP

ACCENDERE	1	<input type="checkbox"/>	<input type="checkbox"/>	SPENTO
	2	<input type="checkbox"/>	<input type="checkbox"/>	

1: LFPT	ACCENDERE: Abilita LFPT (Default)
	SPENTO: Disabilita LFPT
2: EEE (Risparmio energetico)	ACCENDERE: Abilita EEE
	SPENTO: Disabilita EEE (Default)

Indicatore LED**TI-F11SFP/TI-F711SFP**

LED	Stato	Descrizione
PWR	Verde fisso	Alimentazione presente
	Spento	Nessuna alimentazione presente
Porta Ethernet	Verde fisso	Connessione stabilita a 10/100/1000Mbps
	Verde lampeggiante	Trasmissione/ricezione dati
	Spento	Nessuna connessione
Porta SFP	Verde fisso	Connessione stabilita a 1Gbps
	Verde lampeggiante	Trasmissione/ricezione dati
	Spento	Nessuna connessione

TI-BF711SFP

LED	Stato	Descrizione
PWR	Verde fisso	Alimentazione presente
	Spento	Nessuna alimentazione presente
Porta Ethernet	Verde fisso	Connessione stabilita a 10/100/1000Mbps
	Verde lampeggiante	Trasmissione/ricezione dati
	Spento	Nessuna connessione
Porta SFP	Verde fisso	Connessione stabilita a 1Gbps
	Verde lampeggiante	Trasmissione/ricezione dati
	Spento	Nessuna connessione
PoE+	Verde fisso	PoE Connesso
	Spento	Nessuna connessione PoE

Declaration of Conformity

TRENDNET®

Manufacturer's Name and Address

TRENDnet, Inc. Zwolsestraat 156 2587 WB
20675 Manhattan Place The Hague The Netherlands
Torrance, CA 90501 USA



Product Information:

Model Number: TI-F11SFP/TI-F711SFP/TI-BF711SFP/TI-UF11SFP/TI-PF11SFP

Product Name: Industrial 100/1000Base-T to SFP Media Converter
Industrial 10G SFP+ Media Converter
Industrial 10G SFP+ to 10G PoE++ Media Converter
Industrial SFP to Gigabit UPoE Media Converter
Industrial SFP to Gigabit PoE+ Media Converter

Trade Name: TRENDnet

TRENDnet hereby declare that the product is in compliance with the essential requirements and other relevant provisions under our sole responsibility.

Safety EN IEC 62368-1:2020+A11:2020

EMC EN 55032:2015/A1:2020 EN 61000-3-3:2013+A2:2021
EN 55035:2017/A11:2020 EN IEC 61000-6-2:2019
EN IEC 61000-3-2:2019+A1:2021 EN IEC 61000-6-4:2019

This product is herewith confirmed to comply with the Directives.

Directives: EMC Directive 2014/30/EU
RoHS Directive (EU) 2015/863
RoHS Directive 2011/65/EU
WEEE Directive 2012/19/EU
REACH Regulation (EC) No. 1907/2006
Low Voltage Directive 2014/35/EU

Person responsible for this declaration.

Place of Issue: Torrance, California, USA

Date: February 12, 2025

Name: Sonny Su

Title: VP of Technology

Signature:

A handwritten signature in black ink, appearing to read 'Sonny Su', is written over a horizontal line.



Déclaration de conformité

TRENDNET®

Nom et adresse du fabricant

TRENDnet, Inc. Zwolsestraat 156 2587 WB
20675 Manhattan Place The Hague The Netherlands
Torrance, CA 90501 USA



Détails du produit:

Modèle: TI-F11SFP/TI-F711SFP/TI-BF711SFP/TI-UF11SFP/TI-PF11SFP

Nom du produit: Convertisseur de médias industriel 100/1000Base-T vers SFP
Convertisseur industriel de médias SFP+ 10G
Convertisseur industriel de médias SFP+ 10G vers PoE++ 10G
Convertisseur de média UPoE SFP vers Gigabit industriel
Convertisseur de média PoE+ SFP vers Gigabit industriel

Nom Commercial: TRENDnet

TRENDnet déclare par la présente que le produit est conforme aux exigences essentielles et aux autres dispositions pertinentes de la Directive en vertu de notre seule responsabilité.

Sécurité EN IEC 62368-1:2020+A11:2020

CEM EN 55032:2015/A1:2020 EN 61000-3-3:2013+A2:2021
EN 55035:2017/A11:2020 EN IEC 61000-6-2:2019
EN IEC 61000-3-2:2019+A1:2021 EN IEC 61000-6-4:2019

Ce produit est conforme à la directives suivante.

Déclaration: Directive CEM 2014/30/UE
Directive RoHS 2015/863/UE
Directive RoHS 2011/65/UE
Directive WEEE 2012/19/UE
REACH Règlement (CE) N° 1907/2006
Directive Basse Tension 2014/35/UE

Personne responsable de cette déclaration.

Lieu de délivrance: Torrance, California, USA

Date: 12 février, 2025

Nom: Sonny Su

Position: Vice-président de Technologie

Signature:



Konformitätserklärung

TRENDNET[®]

Name und Adresse des Herstellers

TRENDnet, Inc. Zwolsestraat 156 2587 WB
20675 Manhattan Place The Hague The Netherlands
Torrance, CA 90501 USA



Informationen zum Produkt:

Modellnummer: TI-F11SFP/TI-F711SFP/TI-BF711SFP/TI-UF11SFP/TI-PF11SFP

Produktname: Industrieller 100/1000Base-T-zu-SFP-Medienkonverter
Industrieller 10G-SFP+-Medienkonverter
Industrieller 10G SFP+ zu 10G PoE++ Medienkonverter
Industrieller SFP zu Gigabit UPoE Medienkonverter
Industrieller SFP zu Gigabit PoE+ Medienkonverter

Handelsname: TRENDnet

TRENDnet erklärt hiermit, dass das Produkt den grundlegenden Anforderungen und anderen relevanten Bestimmungen unter unserer alleinigen Verantwortung entspricht.

Sicherheit: EN IEC 62368-1:2020+A11:2020

EMV: EN 55032:2015/A1:2020 EN 61000-3-3:2013+A2:2021
EN 55035:2017/A11:2020 EN IEC 61000-6-2:2019
EN IEC 61000-3-2:2019+A1:2021 EN IEC 61000-6-4:2019

Hiermit wird bestätigt, dass dieses Produkt den folgenden Richtlinien entspricht.

Richtlinien: EMV-Richtlinie 2014/30/EU
RoHS-Richtlinie 2015/863/EU
RoHS-Richtlinie 2011/65/EU
WEEE-Richtlinie 2012/19/EU
REACH-Verordnung (EG) Nr. 1907/2006
Niederspannungsrichtlinie 2014/35/EU

Für diese Erklärung verantwortliche Person.

Ort der Ausstellung: Torrance, California, USA

Datum: Februar 12, 2025

Name: Sonny Su

Titel: Vizepräsident für Technologie

Unterschrift: _____



Declaration of Conformity

TRENDNET[®]

Manufacturer's Name and Address

TRENDnet, Inc. Authorized Representative:
20675 Manhattan Place Office: +44 (0) 1635 887 399
Torrance, CA 90501 USA Unit 4 Rivermead Business Park,
Pipers Way, Thatcham, RG19 4EP England



Product Information:

Model Number: TI-F11SFP/TI-F711SFP/TI-BF711SFP/TI-UF11SFP/TI-PF11SFP

Product Name: Industrial 100/1000Base-T to SFP Media Converter
Industrial 10G SFP+ Media Converter
Industrial 10G SFP+ to 10G PoE++ Media Converter
Industrial SFP to Gigabit UPoE Media Converter
Industrial SFP to Gigabit PoE+ Media Converter

Trade Name: TRENDnet

TRENDnet hereby declare that the product is in compliance with the essential requirements and other relevant provisions under our sole responsibility.

Safety EN IEC 62368-1:2020+A11:2020

EMC BS EN 55032:2015/A1:2020 BS EN 61000-3-3:2013+A2:2011
BS EN 55035:2017/A11:2020 BS EN IEC 61000-6-2:2019
BS EN IEC 61000-3-2:2019+A1:2021 BS EN IEC 61000-6-4:2019

This product is herewith confirmed to comply with the Directives.

Directives: Electromagnetic Compatibility Regulations 2016
The Restriction of the Use of Certain Hazardous Substances in
Electrical and Electronic Equipment Regulations 2012
The Waste Electrical and Electronic Equipment Regulations 2013
(as amended)
The REACH Enforcement Regulations 2008 (as amended)
Electrical Equipment (Safety) Regulations 2016

Person responsible for this declaration.

Place of Issue: Torrance, California, USA

Date: February 12, 2025

Name: Sonny Su

Title: VP of Technology

Signature:

A handwritten signature in black ink, appearing to read 'Sonny Su', is written over a horizontal line.



TRENDNET®

Certifications

This device complies with Part 15 of the FCC Rules.

Operation is subject to the following two conditions:

- (1) This device may not cause harmful interference.
- (2) This device must accept any interference received.

Including interference that may cause undesired operation.



Waste electrical and electronic products must not be disposed of with household waste. Please recycle where facilities exist. Check with your Local Authority or Retailer for recycling advice.

Applies to PoE Products Only: This product is to be connected only to PoE networks without routing to the outside plant.

Note

The Manufacturer is not responsible for any radio or TV interference caused by unauthorized modifications to this equipment. Such modifications could void the user's authority to operate the equipment.

Advertencia

En todos nuestros equipos se mencionan claramente las características del adaptador de alimentación necesario para su funcionamiento. El uso de un adaptador distinto al mencionado puede producir daños físicos y/o daños al equipo conectado. El adaptador de alimentación debe operar con voltaje y frecuencia de la energía eléctrica domiciliar existente en el país o zona de instalación.

Technical Support

If you have any questions regarding the product installation, please contact our Technical Support.

Toll free US/Canada: **1-866-845-3673**

Regional phone numbers available at www.trendnet.com/support

TRENDnet

20675 Manhattan Place
Torrance, CA 90501
USA

Product Warranty Registration

Please take a moment to register your product online. Go to TRENDnet's website at:

www.trendnet.com/register