



## Guide d'installation rapide Quick Installation Guide



**TEG-S50g**  
**TEG-S80g**  
H/W: V1

# Table of Contents

Français .....	1
1. Avant de commencer .....	1
2. Installation du matériel .....	3
3. LEDs .....	4
English .....	6
1. Before You Start .....	6
2. Hardware Installation .....	8
3. LEDs .....	9
Technical Specifications .....	11
Dépannage .....	13
Troubleshooting .....	14



## Contenu de l'emballage

- TEG-S50g/TEG-S80g
- Guide d'installation rapide
- Adaptateur secteur (7.5V DC, 1A)

## Configuration du système

- Un ordinateur avec un adaptateur réseau correctement installé
- Câble CAT 5e ou CAT 6 pour réseaux
- La surface doit supporter au moins 1,5 kg pour le Switch
- La prise secteur doit être située à un maximum de 1,82 mètres du Switch
- Inspectez visuellement la prise d'alimentation et assurez-vous qu'elle est correctement connectée à l'adaptateur secteur
- Vérifiez la présence d'une source de ventilation adéquate autour du Switch pour une dissipation efficace de la chaleur
- Ne placez pas d'objets lourds sur le Switch

# Application

## TEG-S50g

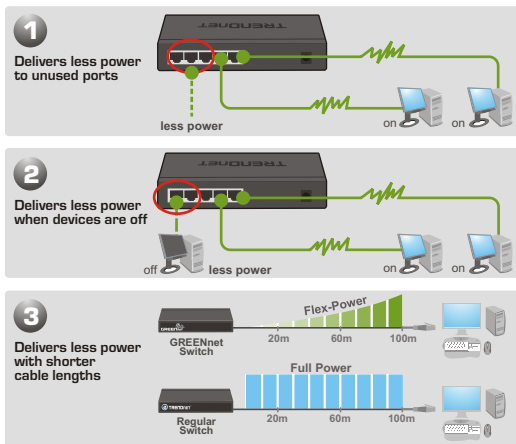

\*Max power savings compared with standard TRENDnet switches.

## TEG-S80g

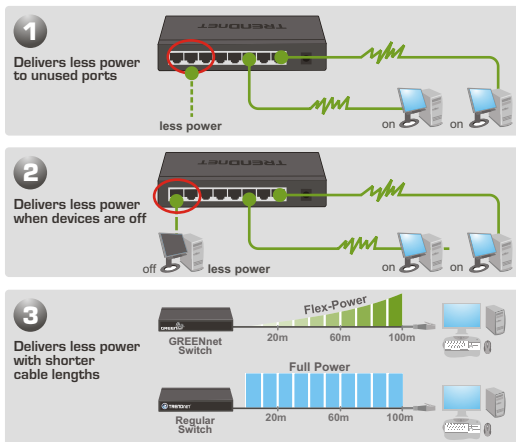

\*Max power savings compared with standard TRENDnet switches.

## 2. Installation du matériel

1. Branchez le **transformateur AC** au TEG-S50g/TEG-S80g ainsi qu'à une prise de courant.



2. Branchez un câble réseau CAT-5e ou CAT-6 RJ-45 de l'ordinateur vers un port Ethernet disponible du TEG-S50g/TEG-S80g.



### TEG-S50g

#### **Alimentation**

Vert : sous tension.

Eteint : hors tension.

#### **Link/ACT**

Vert (Fixe) : Relié à un autrepériphérique.

Vert (Clignotant) : Activité depuis cette liaison

Eteint : Rien n'est détecté sur le port.



#### **1000Mbps**

Vert : la connexion du port est de 1000 (Full) Eteint : la connexion pour le port est de 10 ou 100 ou rien n'est détecté sur le port.

#### **100Mbps**

Vert : la connexion du port est de 100 (Full/Half)  
Eteint : la connexion pour le port est de 10(Full/Half) ou 1000 (Full) ou rien n'est détecté sur le port.

## TEG-S80g

### Alimentation

Vert : sous tension.

Eteint : hors tension.

### Link/ACT

Vert (Fixe) : Relié à un autre périphérique.

Vert (Clignotant) : Activité depuis cette liaison

Eteint : Rien n'est détecté sur le port.



### 100/1000Mbps

Vert: la connexion du port est de 1000 (Full)

Ambre: la connexion du port est de 100 (Full/Half)

Eteint : la connexion pour le port est de 10(Full/Half) ou rien n'est détecté sur le port.

**L'installation est maintenant complète.**

### Enregistrez votre produit

Afin d'être sûr de recevoir le meilleur niveau de service clientèle et le meilleur support possibles, veuillez prendre le temps d'enregistrer votre produit en ligne sur:

[www.trendnet.com/register](http://www.trendnet.com/register)

Nous vous remercions d'avoir choisi Trendnet

# 1. Before You Start



## Package Contents

- TEG-S50g/TEG-S80g
- Quick Installation Guide
- AC Power Adapter (7.5V DC, 1A)

## Installation Requirements

- A computer with a network adapter installed
- Cat-5e or Cat-6 Network Cable
- The surface must support at least 1.5 Kg for the Switch
- The power outlet should be within 1.82 meters (6 feet) of the Switch
- Visually inspect the DC power jack to make sure that it is securely connected to the power adapter
- Make sure that there is proper heat dissipation from and adequate ventilation around the Switch
- Do not place heavy objects on the Switch



# Application

## TEG-S50g

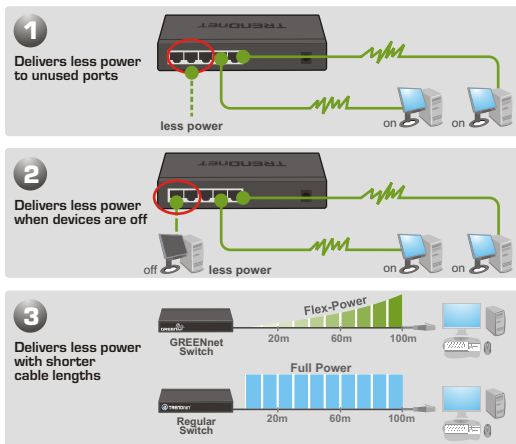

\*Max power savings compared with standard TRENDnet switches.

## TEG-S80g

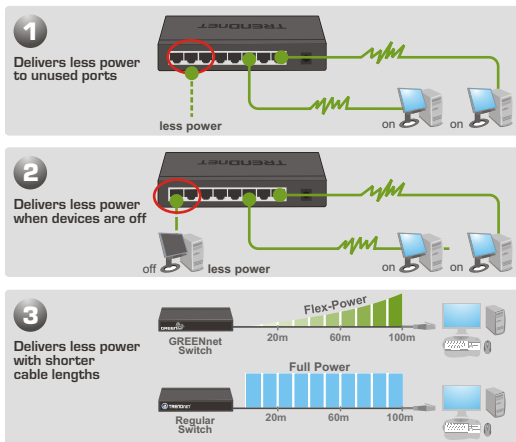

\*Max power savings compared with standard TRENDnet switches.

## 2. Hardware Installation

1. Connect the **AC Power Adapter** to the TEG-S50g/TEG-S80g and then to a power outlet.



2. Connect a CAT-5e or CAT-6 RJ-45 network cable from the computer to an available Ethernet port of the TEG-S50g/TEG-S80g.



### TEG-S50g

#### Power

Green: Power is on.  
Not Illuminated: Power is off.

#### Link/ACT

Green(Solid): Link to another device.  
Green(Blinking): Activity is occurring from the link  
Not Illuminated: Nothing is detected on the port.



#### 1000Mbps

Green: Connection for the port is 1000 (Full)  
Not Illuminated: Connection for the port is 10 or 100 or nothing is detected on the port.

#### 100Mbps

Green: Connection for the port is 100 (Full)  
Not Illuminated: Connection for the port is 10(Full/Half) or 1000(Full/Half) or nothing is detected on the port.

## TEG-S80g

### Power

Green: Power is on.  
Not Illuminated: Power is off.

### Link/ACT

Green(Solid): Link to another device.  
Green(Blinking): Activity is occurring from the link  
Not Illuminated: Nothing is detected on the port.



### 100/1000Mbps

Green: Connection for the port is 1000 (Full)  
Amber: Connection for the port is 100 (Full/Half)  
Not Illuminated: Connection for the port is 10(Full/Half) or nothing is detected on the port.

**Your configuration is now complete.**

### Register Your Product

To ensure the highest level of customer service and support, please take a moment to register your product Online at: [www.trendnet.com/register](http://www.trendnet.com/register)  
Thank you for choosing TRENDnet

Hardware	
<b>Standards</b>	IEEE 802.3 10BASE-T IEEE 802.3u 100BASE-TX IEEE 802.3ab 1000BASE-T IEEE 802.3x Flow Control
<b>Network Media</b>	Ethernet: 2-Pair UTP/STP CAT-3, -4, -5 Fast Ethernet: 2-Pair UTP/STP CAT-5, -5e , -6 Gigabit : 4-Pair UTP/STP CAT-5e, CAT-6 (Recommended)
<b>Data Transfer Rate</b>	Ethernet: 10Mbps (half-duplex), 20Mbps (full-duplex) Fast Ethernet: 100Mbps (half-duplex), 200Mbps (full-duplex) Gigabit Ethernet: 2000Mbps (full-duplex)
<b>Protocol/Topology</b>	CSMA/CD / Star
<b>Interface</b>	TEG-S50g: 5 x 10/100/1000 Auto-MDIX RJ-45 ports TEG-S80g: 8 x 10/100/1000 Auto-MDIX RJ-45 ports
<b>Data RAM Buffer</b>	TEG-S50g: 104KBytes per device TEG-S80g: 128Kbytes per device
<b>Jumbo Frame Support</b>	TEG-S50g: Up to 12Kbytes TEG-S80g: Up to 9612Bytes
<b>Packet Filtering/ Forwarding Rate</b>	10Mbps Ethernet: 14,880pps (packet per second) 100Mbps Fast Ethernet: 148,800pps 1000Mbps Gigabit Ethernet: 1,488,000pps
<b>MAC Address Learning</b>	Automatic Update
<b>Filtering Table</b>	TEG-S50g: 4K entries per device TEG-S80g: 4K entries per device
<b>Switch Fabric</b>	TEG-S50g: 10Gbps Forwarding Capacity TEG-S80g: 16Gbps Forwarding Capacity
<b>Power Consumption</b>	TEG-S50g: 3.67W (max) TEG-S80g: 5W (max)

Hardware	
<b>Diagnostic LEDs</b>	TEG-S50g: Power, Link/ACT, 100Mbps, 1000Mbps TEG-S80g: Power, Link/ACT, 100/1000Mbps
<b>Power Adapter</b>	7.5V DC, 1A External Power Adapter
<b>Dimensions</b>	171 x 98 x 28 mm (6.7 x 3.86 x 1.1 in.)
<b>Weight</b>	TEG-S50g: 430g TEG-S80g <sup>†</sup> 450g
<b>Temperature</b>	Operating: 0° ~ 40° C (32° ~ 104° F) Storage: -10° ~ 70° C (14° ~ 158° F)
<b>Humidity</b>	Operating: 10% ~ 90% Storage: 5% ~ 90%
<b>Certification</b>	CE, FCC

**Q1: Les voyants ne s'allument pas lorsque le Switch est branché sur le secteur.**

**R1:** Vérifiez que l'adaptateur d'alimentation externe du TEG-S50g/TEG-S80g est bien branché à la prise de courant. Vérifiez également que la prise murale est sous tension.

**Q2: Lorsque je branche un ordinateur à l'un des ports du Switch, le voyant Link/ACT s'allume, mais je n'arrive pas à obtenir des vitesses Gigabit.**

**R2:** En premier, regardez les voyants. Avec le TEG-S50g, si le voyant 1000Mbps n'est pas allumé, la vitesse de connexion de l'ordinateur est de 10Mbps ou de 100Mbps. Si vous avez le modèle TEG-S80g, et que le voyant 100/1000Mbps est allumé, la vitesse de connexion est de 100Mbps. Si le voyant 100/1000Mbps est éteint, la vitesse de connexion de l'ordinateur est de 10Mbps. Ensuite, vérifiez le câble Ethernet. Assurez-vous que vous utilisez des câbles Ethernet CAT-5e ou CAT-6. Certains câbles CAT-5 ne permettent pas les connexions Gigabit. Enfin, assurez-vous que vous avez bien une carte réseau Ethernet Gigabit installée sur votre ordinateur.

**Q3: Après avoir connecté mon PC au Switch, je n'arrive pas à partager mes fichiers.**

**R3:** En premier, regardez les voyants du Switch. Assurez-vous que le voyant Link/ACT est allumé. Deuxièmement, vérifiez le câble réseau. La longueur minimale du câble est de 1,5 mètre et la longueur maximale est de 100 mètres. Troisièmement, désactivez tous les programmes de pare-feu. Quatrièmement, vérifiez que le partage des fichiers est activé. Veuillez contacter l'assistance technique de votre système d'exploitation pour plus de renseignements.

**Q4: Une fois que mon PC est connecté au Switch, je n'arrive à accéder à l'Internet qu'avec un seul ordinateur.**

**R4:** Le Switch n'est pas conçu pour partager une connexion internet entre plusieurs ordinateurs. Vous avez besoin d'un routeur Internet, comme le Tw100-S4W1CA, par exemple.

**Q5: Où se trouve le port Uplink du Switch ?**

**R5:** Comme tous les ports du Switch sont Auto-MDIX, tous les ports peuvent être utilisés comme des ports uplink.

Si vous avez la moindre question concernant la **TEG-S50g/TEG-S80g** veuillez contacter le département d'assistance technique de TRENDnet.

**Q1: After connecting the Switch to a power outlet, the LEDs do not turn on.**

**A1:** Check the connection of the external power adapter to the TEG-S50g/TEG-S80g and the power outlet. Also check that the power outlet is receiving power.

**Q2: When I connect a computer to one of the ports on the Switch, the Power and the Link/ACT LED is lit, but I am not getting Gigabit speeds.**

**A2:** First, check the LEDs. If you have the TEG-S50g, if the 1000Mbps LED is off, the computer's connection speed is 10Mbps or 100Mbps. If you have the TEG-S80g, if the 100/1000Mbps LED is amber, the computer's connection speed is 100Mbps. If the 100/1000Mbps LED is off, the computer's connection speed is 10Mbps. Second, check the Ethernet Cable. Make sure you are using CAT-5e or CAT-6 Ethernet Cables. Some CAT-5 cables are not rated to run in Gigabit. Third, make sure that you have a Gigabit Ethernet adapter installed on your computer.

**Q3: After I connect my PCs to the Switch, I am unable to share files.**

**A3:** First, check the LEDs on the Switch. Make sure the Link/ACT LED is on. Second, check the network cable. The minimum length of the cable is 1.5 meters and the maximum length of the cable is 100 meters. Third, disable any software firewall program. Fourth, verify that you have file sharing enabled. Please contact your Operating System support for more information.

**Q4: After I connect my PCs to the Switch, I can only get onto the Internet from one computer.**

**A4:** The Switch was not designed to share Internet between multiple computers. You need to get an Internet router such as the TW100-S4W1CA.

**Q5: Where is the uplink port located on the Switch?**

**A5:** Since all the ports on the Switch are Auto-MDIX, any of the ports can be used as an uplink port.

If you still encounter problems or have any questions regarding the TEG-S50g/TEG-S80g please contact Trendnet's Technical Support Department.



## Limited Warranty

TRENDnet warrants its products against defects in material and workmanship, under normal use and service, for the following lengths of time from the date of purchase.

<b>TEG-S50g/TEG-S80g</b>	<b>5-Year Limited Warranty</b>
--------------------------	--------------------------------

If a product does not operate as warranted above during the applicable warranty period, TRENDnet shall, at its option and expense, repair the defective product or deliver to customer an equivalent product to replace the defective item. All products that are replaced will become the property of TRENDnet. Replacement products may be new or reconditioned.

TRENDnet shall not be responsible for any software, firmware, information, or memory data of customer contained in, stored on, or integrated with any products returned to TRENDnet pursuant to any warranty.

There are no user serviceable parts inside the product. Do not remove or attempt to service the product through any unauthorized service center. This warranty is voided if (i) the product has been modified or repaired by any unauthorized service center, (ii) the product was subject to accident, abuse, or improper use (iii) the product was subject to conditions more severe than those specified in the manual.

Warranty service may be obtained by contacting TRENDnet office within the applicable warranty period for a Return Material Authorization (RMA) number, accompanied by a copy of the dated proof of the purchase. Products returned to TRENDnet must be pre-authorized by TRENDnet with RMA number marked on the outside of the package, and sent prepaid, insured and packaged appropriately for safe shipment.

WARRANTIES EXCLUSIVE: IF THE TRENDNET PRODUCT DOES NOT OPERATE AS WARRANTED ABOVE, THE CUSTOMER'S SOLE REMEDY SHALL BE, AT TRENDNET'S OPTION, REPAIR OR REPLACEMENT. THE FOREGOING WARRANTIES AND REMEDIES ARE EXCLUSIVE AND ARE IN LIEU OF ALL OTHER WARRANTIES, EXPRESSED OR IMPLIED, EITHER IN FACT OR BY OPERATION OF LAW, STATUTORY OR OTHERWISE, INCLUDING WARRANTIES OF MERCHANTABILITY AND FITNESS FOR A PARTICULAR PURPOSE. TRENDNET NEITHER ASSUMES NOR AUTHORIZES ANY OTHER PERSON TO ASSUME FOR IT ANY OTHER LIABILITY IN CONNECTION WITH THE SALE, INSTALLATION, MAINTENANCE OR USE OF TRENDNET'S PRODUCTS.

TRENDNET SHALL NOT BE LIABLE UNDER THIS WARRANTY IF ITS TESTING AND EXAMINATION DISCLOSE THAT THE ALLEGED DEFECT IN THE PRODUCT DOES NOT EXIST OR WAS CAUSED BY CUSTOMER'S OR ANY THIRD PERSON'S MISUSE, NEGLIGENCE, IMPROPER INSTALLATION OR TESTING, UNAUTHORIZED ATTEMPTS TO REPAIR OR MODIFY, OR ANY OTHER CAUSE BEYOND THE RANGE OF THE INTENDED USE, OR BY ACCIDENT, FIRE, LIGHTNING, OR OTHER HAZARD.

LIMITATION OF LIABILITY: TO THE FULL EXTENT ALLOWED BY LAW TRENDNET ALSO EXCLUDES FOR ITSELF AND ITS SUPPLIERS ANY LIABILITY, WHETHER BASED IN CONTRACT OR TORT (INCLUDING NEGLIGENCE), FOR INCIDENTAL, CONSEQUENTIAL, INDIRECT, SPECIAL, OR PUNITIVE DAMAGES OF ANY KIND, OR FOR LOSS OF REVENUE OR PROFITS, LOSS OF BUSINESS, LOSS OF INFORMATION OR DATA, OR OTHER FINANCIAL LOSS ARISING OUT OF OR IN CONNECTION WITH THE SALE, INSTALLATION, MAINTENANCE, USE, PERFORMANCE, FAILURE, OR INTERRUPTION OF THE POSSIBILITY OF SUCH DAMAGES, AND LIMITS ITS LIABILITY TO REPAIR, REPLACEMENT, OR REFUND OF THE PURCHASE PRICE PAID, AT TRENDNET'S OPTION. THIS DISCLAIMER OF LIABILITY FOR DAMAGES WILL NOT BE AFFECTED IF ANY REMEDY PROVIDED HEREIN SHALL FAIL OF ITS ESSENTIAL PURPOSE.

Governing Law: This Limited Warranty shall be governed by the laws of the state of California.

Note: AC/DC Power Adapter, Cooling Fan, Cables and Power Supply carry a 1-Year Warranty

## Certifications

This equipment has been tested and found to comply with FCC and CE Rules.

Operation is subject to the following two conditions:

- (1) This device may not cause harmful interference.
- (2) This device must accept any interference received. Including interference that may cause undesired operation.



Waste electrical and electronic products must not be disposed of with household waste. Please recycle where facilities exist. Check with you Local Authority or Retailer for recycling advice.



**NOTE:** THE MANUFACTURER IS NOT RESPONSIBLE FOR ANY RADIO OR TV INTERFERENCE CAUSED BY UNAUTHORIZED MODIFICATIONS TO THIS EQUIPMENT. SUCH MODIFICATIONS COULD VOID THE USER'S AUTHORITY TO OPERATE THE EQUIPMENT.

## ADVERTENCIA

En todos nuestros equipos se mencionan claramente las características del adaptador de alimentación necesario para su funcionamiento. El uso de un adaptador distinto al mencionado puede producir daños físicos y/o daños al equipo conectado. El adaptador de alimentación debe operar con voltaje y frecuencia de la energía eléctrica domiciliar existente en el país o zona de instalación.



**TRENDnet**<sup>®</sup>

## Product Warranty Registration

Please take a moment to register your product online.  
Go to TRENDnet's website at <http://www.trendnet.com/register>

**TRENDnet**<sup>®</sup>

20675 Manhattan Place  
Torrance, CA 90501  
USA