

## 5-Port Hardened Industrial Gigabit DIN-Rail Switch

### TI-G50 (v1.1R)

- 5 x Gigabit Ethernet ports
- 10 Gbps switching capacity
- Hardened IP30 rated metal switch
- Includes DIN-rail and wall mounts
- Extreme -40 to 75 °C (-40 to 167 °F) operating temperature range
- Dual redundant power inputs with overload current protection
- Power supply sold separately (model TI-M6024)
- Limited Lifetime Warranty

TRENDnet's TI-G50 is a reliable IP30 unmanaged DIN-rail switch with hardened components rated for extreme industrial environments. It offers 5 Gigabit ports and a 10 Gbps switching capacity. Dual redundant power inputs (power adapter sold separately: TI-M6024) with overload current protection support zero downtime applications.



### Network Ports

5 x Gigabit Ethernet ports



### DIN-Rail/Wall Mounts

IP30 rated metal enclosure with included DIN-rail and wall mount hardware



### Switching Capacity

10 Gbps switching capacity



### Redundant Power

Dual redundant power inputs with overload current protection (power supply sold separately: model TI-M6024)



### Extreme Temperatures

Hardened switch is rated for an operating temperature range of -40 to 75 °C (-40 to 167 °F)



### Electro Magnetic Compliance

Complies with FCC Part 15 Subpart B Class A and CE EN 55022 Class A standards



### Shock and Vibration Resistant

Rated for shock (IEC 60068-2-27), freefall (IEC 60068-2-32), and vibration (IEC 60068-2-6)



### Grounding Point

Grounding point protects equipment from external electrical surges

## Networking Solution

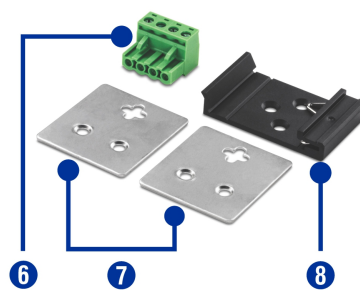
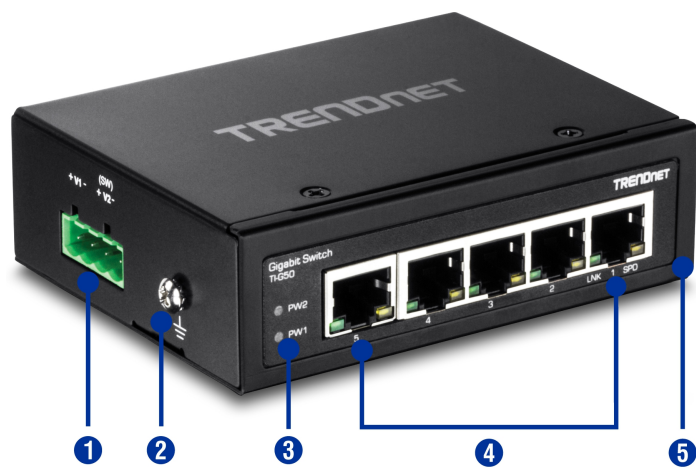

- 1 Terminal block slot
- 2 Grounding point
- 3 LED indicators
- 4 Gigabit Ethernet ports
- 5 IP30 rated metal housing
- 6 Terminal block
- 7 Wall mounting kit
- 8 DIN-rail mount

## Specifications

### Standards

- IEEE 802.3
- IEEE 802.3u
- IEEE 802.3ab
- IEEE 802.3x

### Device Interface

- 5 x Gigabit ports
- 4-pin removable terminal block
- LED indicators
- DIN-Rail mount
- Wall mount
- Grounding point

### Data Transfer Rate

- Ethernet: 10 Mbps (half duplex), 20 Mbps (full duplex)
- Fast Ethernet: 100 Mbps (half duplex), 200 Mbps (full duplex)
- Gigabit: 2000 Mbps (full duplex)

### Performance

- Data RAM Buffer: 1024 KB
- Switching Fabric: 10 Gbps
- MAC Address Table: 8 K entries
- Forwarding rate: 7.44 Mpps (64-byte packet size)

### Special Features

- Hardened components rated for extreme temperatures
- Dual redundant power inputs
- Auto-Negotiation
- Auto store and forward architecture
- Automatic address learning and address aging
- ESD 8 KV and Surge 6 KV protection

### Power

- Input: 12 - 56 V DC or 18 - 36 V AC
- Compatible power supply: TI-M6024 (sold separately)
- Consumption: Max. 2.76 Watts

### Terminal Block

- Redundant power inputs, 4 pin
- Wire range: 0.34 mm<sup>2</sup> to 2.5 mm<sup>2</sup>

- Solid wire (AWG): 12-24/14-22
- Stranded wire (AWG): 12-24/14-22
- Torque: 5 lb. – In / 0.5 Nm / 0.56 Nm
- Wire strip length: 7-8 mm

### MTBF

- 510,304 hours

### Housing

- IP30 metal case
- DIN-rail mount
- Wall mount
- Grounding point
- 8 KV ESD protection
- 6 KV surge protection

### Operating Temperature

- - 40 to 75 °C (-40 to 167 °F)

### Operating Humidity

- Max. 95 % non-condensing

### Dimensions

- 113 x 82 x 31 mm (4.4 x 3.2 x 1.2 in.)

### Weight

- 168 g (5.9 oz.)

### Certifications

- CE
- FCC
- Shock (IEC 60068-2-27)
- Freefall (IEC 60068-2-32)
- Vibration (IEC 60068-2-6)

### Warranty

- Limited Lifetime Warranty

### Package Contents

- TI-G50
- Quick Installation Guide
- Removable terminal block
- DIN-rail / wall mount kit

TRENDnet offers a limited lifetime warranty for all of its metal-enclosed network switches that have been purchased in the United States/Canada on or after 1/1/2015. Cooling fan and internal power supply carry a one-year warranty.