



Quick Installation Guide

Unmanaged Industrial Switch

Table of Contents

1 English

1. Before You Start
2. Quick Reference
3. Hardware Installation

1. Before You Start

Package Contents

- TI-G50 / TI-G62 / TI-G80 / TI-G102 / TI-G162 / TI-E50 / TI-E80
- Quick Installation Guide
- Removable terminal block
- DIN-Rail mount
- Wall mount kit

Minimum Requirements

- Existing network
- Power Supply

Switch Consumption Table

Switch Model	Switch Power Consumption	DC Input Voltage Range
TI-G50	2.76W	12 – 56V
TI-G102	5.76W	12 – 56V
TI-G62	3.84W	12 – 56V
TI-G162	13W	12 – 56V
TI-G80	5W	12 – 56V
TI-E50	2.24W	12 – 56V
TI-E80	3W	12 – 56V

Unmanaged Industrial Switch Model Power Supplies.

Power Supply Model	Max. Power Supplied	DC Output	Type	Note
TI-M6024	60W	24V / 2.5A	DIN-Rail	
TI-S12024	120W	24V / 5A	DIN-Rail	
TI-S12048	120W	48V / 2.5A	DIN-Rail	
TI-S24048	240W	48V / 5A	DIN-Rail	
TI-S48048	480W	48V / 10A	DIN-Rail	
48VDC3000	160W	48V / 3.34A	Power Adapter (4-pin DIN type connector)	Compatible only with TI-G162 / TI-G102

Note: Select the appropriate power supply according to the switch model you have purchased.

2. Quick Reference

Note: The switch model and power supply may be different than the one shown in the example below.

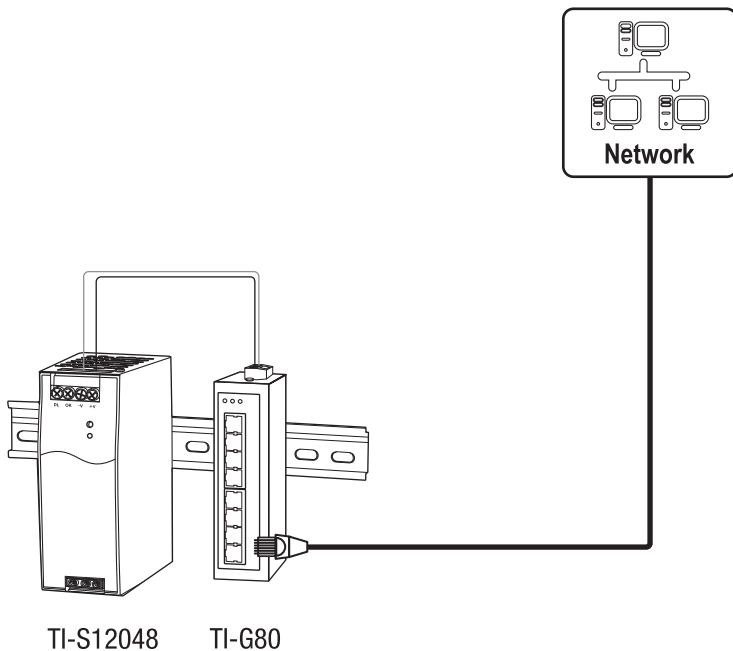

3. Hardware Installation

The switch can be placed on a desktop, wall mounted, or mounted to a DIN-Rail.

DIN-Rail Mounting Instructions

1. Attach the DIN-rail mount bracket to the switch.

Note: The switch may be different than the one shown in the examples below.

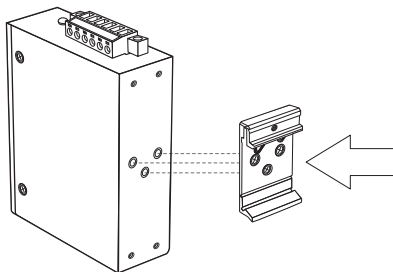

2. Position the unit in front of the DIN-Rail and hook the mount bracket over the top of the rail.
3. Rotate the unit downward towards the rail to lock it into place. You will know it is secure when you hear the click.

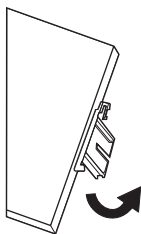

Mounting the unit

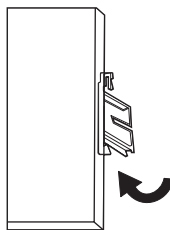

Releasing the unit

4. To remove the unit, pull down to clear the bottom of the DIN-Rail and rotate up, away from the rail.

Wall Mounting Instructions

1. Attach the wall mount plates to switch.
2. Mount the switch.

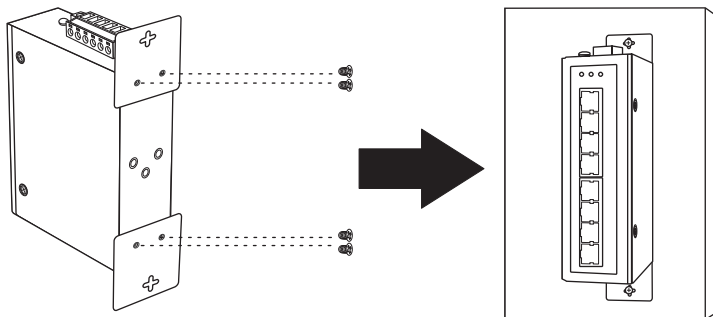

Applying Power

1. Connect the power supply (sold separately) to the included terminal block (as shown below) and secure with the screws.

Note: Polarities must match.

2. Attach the terminal block to the unit, connect the ground wire to the ground, and supply power to the power adapter.

Note: The switch model and power supply may be different than the one shown in the example below. Terminal blocks may be 4-pin (dual power input) or 6-pin (dual power input with alarm relay output) with differences in labeling.

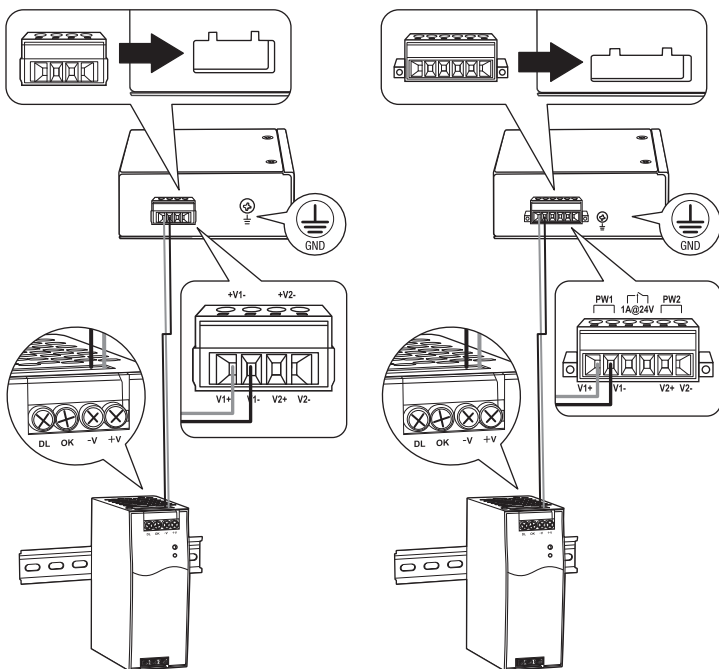

3. Connect a network source and devices to the switch. Check the LEDs to confirm the connections are established. Your installation is completed.

Note: Please refer to the LED definition section on page 8-13 for reference to your switch model.

If available on your switch (TI-G102 / TI-G162), the 4-pin DIN type connector can also be used as an additional power input (48VDC3000 power adapter sold separately).

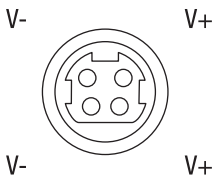

Safety Note



- Turn off the power before connecting any module or wire. The correct power supply voltage is listed on the product label. Check the voltage of your power source to make sure that you are using the correct part. Do NOT use voltage greater than the maximum listed on the product label.
- Calculate the maximum possible current in each power wire and common wire. Observe all electrical codes dictating the maximum current allowable for each wire size. If the current surpasses the maximum ratings, the wiring could overheat, causing serious damage to your equipment.

LED Indicators

TI-G50		
	Status	Description
PW1	Solid Green	Power is Detected
	Off	Power is Not Detected
PW2	Solid Green	Power is Detected
	Off	Power is Not Detected
LNK	Solid Green	Connected
	Flashing Green	Data Transmitting / Receiving
	Off	No Connection
SPD	Solid Amber	Connected at 1000M
	Off	Connected at 10/100M

TI-G102		
	Status	Description
PW1	Solid Green	Power is Detected
	Off	Power is Not Detected
PW2	Solid Green	Power is Detected
	Off	Power is Not Detected
PW3	Solid Amber	Power is Detected
	Off	Power is Not Detected
RLY	Solid Amber	Connected only PW1 or PW2 or PW3
	Off	Both PW1 and PW2 are connected and powered
LNK	Solid Green	Connected
	Flashing Green	Data Transmitting / Receiving
	Off	No Connection
SFP (F9,F10)	Solid Green	Connected
	Flashing Green	Data Transmitting / Receiving
	Off	No Connection

TI-G62		
	Status	Description
PW1	Solid Green	Power is Detected
	Off	Power is Not Detected
PW2	Solid Green	Power is Detected
	Off	Power is Not Detected
ERR	Solid Amber	Both PW1 and PW2 are connected and powered
	Off	Connected only PW1 or PW2
LNK	Solid Green	Connected
	Flashing Green	Data Transmitting / Receiving
	Off	No Connection
SPD	Solid Amber	Connected at 1000Mbps
	Off	Connected at 10/100Mbps
SFP (F5, F6)	Solid Green	Connected
	Flashing Green	Data Transmitting / Receiving
	Off	No Connection

DIP Switch Reference

DIP SWITCH 1	On	Enable Port T5
	Off	Enable Port F5
DIP SWITCH 2	On	SFP Speed is 100Mbps
	Off	SFP Speed is 1000Mbps

TI-G162		
	Status	Description
P1	Solid Green	Power is Detected
	Off	Power is Not Detected
P2	Solid Green	Power is Detected
	Off	Power is Not Detected
P3	Solid Amber	Power is Detected
	Off	Power is Not Detected
RLY	Solid Amber	Connected only PW1 or PW2 or PW3
	Off	Both PW1 and PW2 are connected and powered
LNK	Solid Green	Connected
	Flashing Green	Data Transmitting / Receiving
	Off	No Connection
SFP (F15,F16)	Solid Green	Connected
	Flashing Green	Data Transmitting / Receiving
	Off	No Connection

TI-G80		
	Status	Description
PW1	Solid Green	Power is Detected
	Off	Power is Not Detected
PW2	Solid Green	Power is Detected
	Off	Power is Not Detected
RLY	Solid Amber	Connected only PW1 or PW2
	Off	Both PW1 and PW2 are connected and powered
LNK	Solid Green	Connected
	Flashing Green	Data Transmitting / Receiving
	Off	No Connection

TI-E50		
	Status	Description
PW1	Solid Green	Power is Detected
	Off	Power is Not Detected
PW2	Solid Green	Power is Detected
	Off	Power is Not Detected
LNK	Solid Green	Connected
	Flashing Green	Data Transmitting / Receiving
	Off	No Connection

TI-E80		
	Status	Description
PW1	Solid Green	Power is Detected
	Off	Power is Not Detected
PW2	Solid Green	Power is Detected
	Off	Power is Not Detected
RLY	Solid Amber	Connected only PW1 or PW2
	Off	Both PW1 and PW2 are connected and powered
LNK	Solid Green	Connected
	Flashing Green	Data Transmitting / Receiving
	Off	No Connection

Declaration of Conformity

TRENDnet[®]

Manufacturer's Name and Address

TRENDnet, Inc.
20675 Manhattan Place
Torrance, CA 90501 USA

Zwolsestraat 156 2587 WB
The Hague The Netherlands



Product Information: TI-G50 / TI-G80 / TI-G62 / TI-G102 / TI-G162 / TI-E50 / TI-E80

5-Port Hardened Industrial Gigabit DIN-Rail Switch
8-Port Hardened Industrial Gigabit DIN-Rail Switch
6-Port Hardened Industrial Gigabit DIN-Rail Switch
10-Port Hardened Industrial Gigabit DIN-Rail Switch
16-Port Industrial Gigabit DIN-Rail Switch
5-Port Industrial Fast Ethernet DIN-Rail Switch
8-Port Industrial Fast Ethernet DIN-Rail Switch

Trade Name: TRENDnet

TRENDnet hereby declare that the product is in compliance with the essential requirements and other relevant provisions under our sole responsibility.

EMC EN 55032: 2015 + AC: 2016 (Class A)
EN 55024: 2010 (TI-PG541)
EN 55024: 2010 + A1: 2015
EN 61000-4-2: 2009
EN 61000-4-3: 2006 + A1: 2008 + A2: 2010
EN 61000-4-4: 2012
EN 61000-4-5: 2013 + AC:2015
EN 61000-4-8: 2010

This product is herewith confirmed to comply with the Directives.

Directives: Low Voltage Directive 2014/35/EU
EMC Directive 2014/30/EU
RoHS Directive 2011/65/EU
REACH Regulation (EC) No. 1907/2006

Person responsible for this declaration.

Place of Issue: Torrance, California, USA

Date: December 02, 2019

Name: Sonny Su

Title: Director of Technology

Signature:

A handwritten signature in black ink, appearing to be 'Sonny Su', written over a horizontal line.





Certifications

This device complies with Part 15 of the FCC Rules.

Operation is subject to the following two conditions:

- (1) This device may not cause harmful interference.
- (2) This device must accept any interference received.

Including interference that may cause undesired operation.



Waste electrical and electronic products must not be disposed of with household waste. Please recycle where facilities exist. Check with your Local Authority or Retailer for recycling advice.

Technical Support

If you have any questions regarding the product installation, please contact our Technical Support.

Toll free US/Canada: **1-855-373-4741**

Regional phone numbers available
at www.trendnet.com/support

TRENDnet

20675 Manhattan Place
Torrance, CA 90501
USA

Applies to PoE Products Only: This product is to be connected only to PoE networks without routing to the outside plant.

Note

The Manufacturer is not responsible for any radio or TV interference caused by unauthorized modifications to this equipment. Such modifications could void the user's authority to operate the equipment.

Advertencia

En todos nuestros equipos se mencionan claramente las características del adaptador de alimentación necesario para su funcionamiento. El uso de un adaptador distinto al mencionado puede producir daños físicos y/o daños al equipo conectado. El adaptador de alimentación debe operar con voltaje y frecuencia de la energía eléctrica domiciliar existente en el país o zona de instalación.

Product Warranty Registration

Please take a moment to register your product online. Go to TRENDnet's website at:

www.trendnet.com/register