

TRENDnet[®]

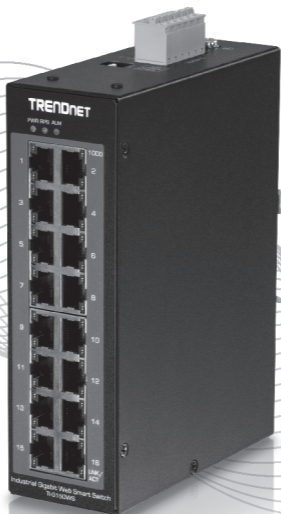

Quick Installation Guide

TI-G160WS

Table of Content

1 English

1. Before You Start
2. Quick Reference
3. Hardware Installation
4. Hardware Configuration
5. Additional Information

1. Before You Start

Package Contents

- TI-G160WS
- Quick Installation Guide

Minimum Requirements

- Power supply (ex. model TI-M6024)
- Networked computer
- RJ-45 Network Cable

Optional Equipment

- 35 mm DIN-Rail

2. Quick Reference

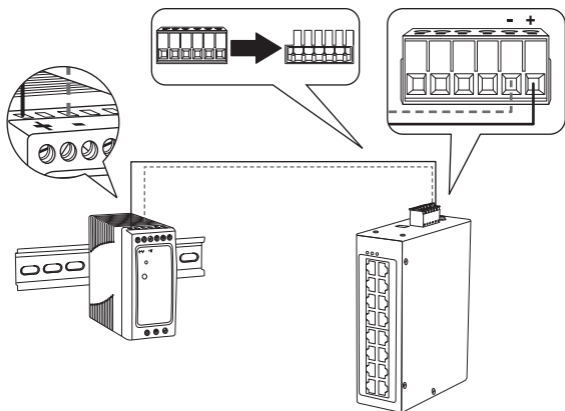

3. Hardware Installation

Note:

The TI-G160WS can be placed on a desktop, wall, or mounted to a DIN-Rail.

DIN-rail Mounting Instructions

1. Attach the DIN-Rail mount to TI-G160WS.

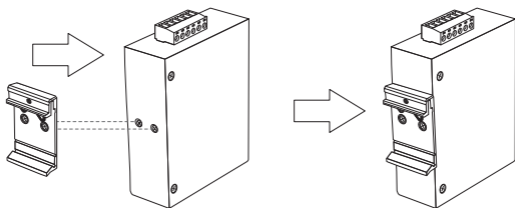

2. Position the unit in front of the DIN-Rail and hook the mount bracket over the top of the rail.
3. Rotate the TI-G160WS downward towards the rail to lock it into place. You will know it is secure when you hear the click.

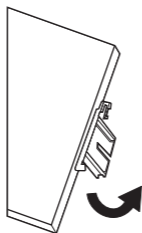

Mounting the unit

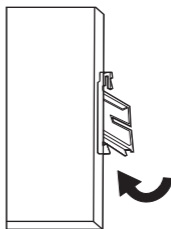

Releasing the unit

4. To remove the unit, pull down to clear the bottom of the DIN-Rail and rotate away from the rail.

Applying Power

1. Connect the power supply (sold separately) to the included terminal block (as shown below) and secure with the screws.

Note: Polarities must match.

2. Attach the terminal block to the unit.

Optional: The switch chassis can also be connected to a known grounding point for additional safety and protection (grounding wire is not included)

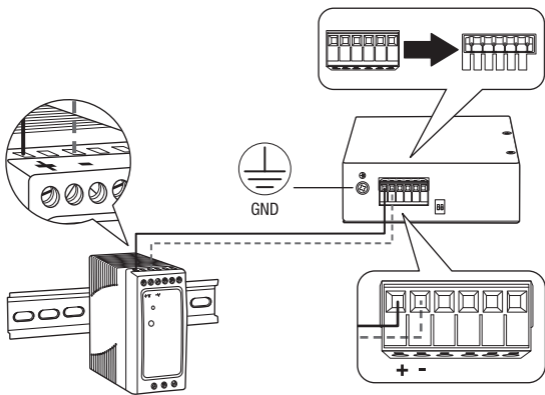

Safety Note



- Turn off the power before connecting any module or wire. The correct power supply voltage (12 – 60 V DC) is listed on the product label. Check the voltage of your power source to make sure that you are using the correct part. Do NOT use voltage greater than 12 – 60 V DC, as specified on the product label.
- Calculate the maximum possible current in each power wire and common wire. Observe all electrical codes dictating the maximum current allowable for each wire size. If the current surpasses the maximum ratings, the wiring could overheat, causing serious damage to your equipment.

4. Hardware Configuration

1

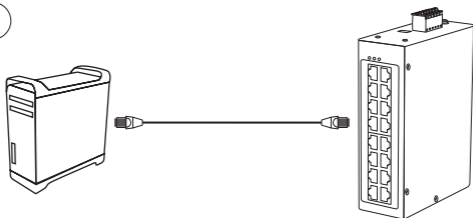

2. Assign a Static IP address to your computer's network adapter in the subnet of 192.168.10.x (e.g. 192.168.10.25) and a subnet mask of 255.255.255.0.
3. Open your web browser, type the IP address of the switch in the address bar, and then press **Enter**.
The default IP address is 192.168.10.200
4. Enter the **User name** and **Password**, and then click **Login**. By default:

User Name: **admin**

Password: **admin**

Note: User Name and Password are case sensitive.

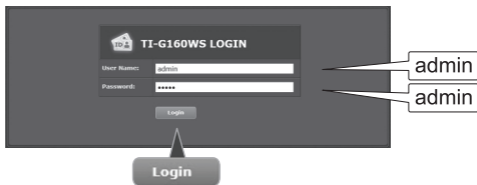

5. Click **Basic Settings** and then click **General Settings**.



6. Configure the switch to match the requirements of your network. Then click **Apply**.

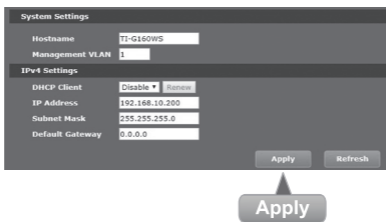

7. Click **Save**.



8. Connect a network source and devices to the switch. Check the LEDs to confirm the connections are established. Your installation is complete.

5. Additional Information

1. Redundant power inputs

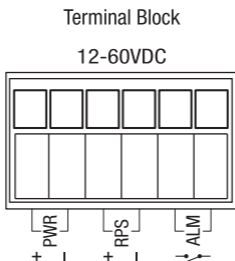

Redundant Power Input: “Terminal Block (PWR)” as primary power and “Terminal Block (RPS)” for secondary power source, to be a redundant power Input.

2. DIP Switch



PWR	ON: Primary power alarm enabled
	OFF: Primary power alarm disabled
RPS	ON: Redundant power alarm enabled
	OFF: Redundant power alarm disabled

3. LED Indicators

PWR	ON: Terminal block PWR is connected
	OFF: Terminal block PWR failure
RPS	ON: Terminal block RPS is connected
	OFF: Terminal block RPS failure
ALM (Red)	ON: PWR/RPS failure
	OFF: No alarm setup
10/100/1000 Mbps	ON: Network speed at 1000 Mbps
	OFF: Network speed at 10/100 Mbps
LINK/ACT	ON: Port connection is established
	Blinking: Data is transmitting/receiving
	OFF: Port disconnected

Note: To download the latest version of the user's guide, please go to <http://www.trendnet.com/support> and select the **TI-G160WS** within the Products Download dropdown list.

Declaration of Conformity

TRENDNET®

Manufacturer's Name and Address

TRENDnet, Inc.
20675 Manhattan Place
Torrance, CA 90501 USA

Zwolsestraat 156 2587 WB
The Hague The Netherlands



Product Information

Model Number: TI-G160WS
Product Name: 16-Port Industrial Gigabit Web Smart DIN-Rail Switch
Trade Name: TRENDnet

TRENDnet hereby declare that the product is in compliance with the essential requirements and other relevant provisions under our sole responsibility.

EMC: EN 61000-3-2: 2014
EN 61000-3-3: 2013
EN 55022: 2010 + AC: 2011 (Class A)
EN 55024: 2010

Energy Efficiency Regulation (EC) No. 1275/2008, No. 801/2013

This product is herewith confirmed to comply with the Directives.

Directives: LVD Directive 2014/35/EU
EMC Directive 2014/30/EU
RoHS Directive 2011/65/EU
REACH Regulation (EC) No. 1907/2006

Person responsible for this declaration.

Place of Issue: Torrance, California, USA

Date: April 02, 2018

Name: Sonny Su

Title: Director of Technology

Signature: _____

A handwritten signature in black ink, appearing to read 'Sonny Su', is written over a horizontal line.



Certifications

This device complies with Part 15 of the FCC Rules.

Operation is subject to the following two conditions:

- (1) This device may not cause harmful interference.
- (2) This device must accept any interference received. Including interference that may cause undesired operation.



Waste electrical and electronic products must not be disposed of with household waste. Please recycle where facilities exist. Check with your Local Authority or Retailer for recycling advice.

Technical Support

If you have any questions regarding the product installation, please contact our Technical Support.

Toll free US/Canada: **1-866-845-3673**

Regional phone numbers available at www.trendnet.com/support

TRENDnet

20675 Manhattan Place
Torrance, CA 90501
USA

Applies to PoE Products Only: This product is to be connected only to PoE networks without routing to the outside plant.

Note

The Manufacturer is not responsible for any radio or TV interference caused by unauthorized modifications to this equipment. Such modifications could void the user's authority to operate the equipment.

Advertencia

En todos nuestros equipos se mencionan claramente las características del adaptador de alimentación necesario para su funcionamiento. El uso de un adaptador distinto al mencionado puede producir daños físicos y/o daños al equipo conectado. El adaptador de alimentación debe operar con voltaje y frecuencia de la energía eléctrica domiciliar existente en el país o zona de instalación.

Product Warranty Registration

Please take a moment to register your product online. Go to TRENDnet's website at: www.trendnet.com/register