

# TRENDnet®



---

## Quick Installation Guide TEG-S50ES/TEG-S80ES (V1)

# Table of Contents

---

## **1 Italiano**

1. Prima di cominciare
2. Riferimento rapido
3. Installazione e configurazione Hardware

# 1. Prima di cominciare

---

## Contenuto della Confezione

- TEG-S50ES/TEG-S80ES
- Guida di Installazione Rapida
- Adattatore di alimentazione (5V CC, 1A)

## Requisiti minimi

- Computer con porta Ethernet e Web browser
- Cavo di rete

# 2. Riferimento rapido

---

**Nota:** Il modello di switch (commutatore) potrebbe essere diverso da quello mostrato nell'esempio seguente.

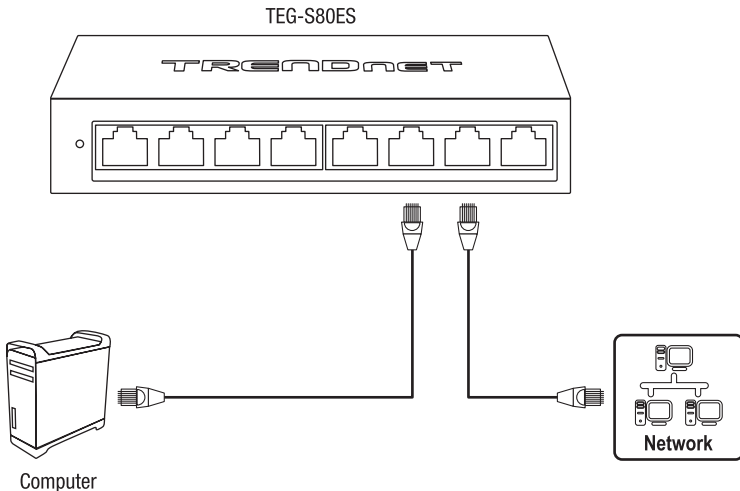

### 3. Installazione e configurazione Hardware

1

Alimentazione

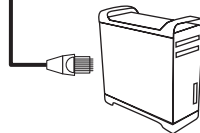
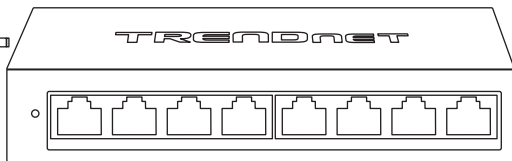

3. Assignare un indirizzo IP statico alla scheda di rete del proprio computer nella sottorete 192.168.10.x (e.g. 192.168.10.25) con subnet mask 255.255.255.0.
4. Aprire il web browser, digitare l'indirizzo IP dello switch nella barra indirizzi e premere **Invio**. L'indirizzo IP di fabbrica è 192.168.10.200.



5. Inserire **User name** e **Password** e cliccare **LOGIN**. Preimpostazioni:

User Name: **admin**

Password: **admin**

**Nota:** User name e Password sono sensibili alle maiuscole/minuscole.

User Name: \_\_\_\_\_

Password: \_\_\_\_\_

LOGIN

6. Cliccare **System** e poi cliccare **IPv4 Setup**.

7. Configurare lo switch secondo i requisiti richiesti dalla propria rete e poi cliccare **Apply**.

**System**

Switch Info

- System
  - System Management
    - IPv4 Setup
    - Administration
    - Network
  - IPv6 Setup
  - Global Settings
    - Community Table Settings
    - Host Settings
  - Statistics
    - IEEE 802.3ad FEE
- Network

IPv4 Setup

System MAC Address: 80-26-89-7C-020-50

System IP Address: 192.168.1.1

System Subnet Mask: 255.255.255.0

System Default Gateway: 192.168.1.1

System IP Mode: Static

DHCP Entry Time: 3 (1-120)

Note: DHCP default entry interval: 3 seconds

Apply

Apply

8. Cliccare **OK**.

**WARNING**

The management session will be disconnected. Use new IP address to connect to device.

OK Cancel

OK

9. Nell'elenco a sinistra clicca **Strumenti** poi clicca su **Configurazione** e successivamente clicca su **Salva**.

10. Cliccare **Save Settings to Flash** (tasto).

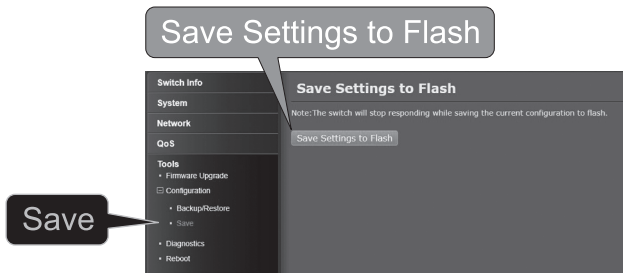

11. Cliccare **OK**.

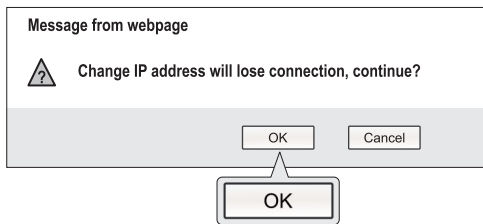

Pre informazioni dettagliate riguardanti la configurazione e le impostazioni avanzate del **TEG-S50ES/TEG-S80ES**, Fare riferimento alla Guida Utente nella pagina di assistenza di TRENDnet, [www.trendnet.com/support](http://www.trendnet.com/support).

# TRENDnet<sup>®</sup>

---

## Certifications

This device complies with Part 15 of the FCC Rules.

Operation is subject to the following two conditions:

- (1) This device may not cause harmful interference.
- (2) This device must accept any interference received.

Including interference that may cause undesired operation.



Waste electrical and electronic products must not be disposed of with household waste. Please recycle where facilities exist. Check with your Local Authority or Retailer for recycling advice.

Applies to PoE Products Only: This product is to be connected only to PoE networks without routing to the outside plant.

## Note

The Manufacturer is not responsible for any radio or TV interference caused by unauthorized modifications to this equipment. Such modifications could void the user's authority to operate the equipment.

## Advertencia

En todos nuestros equipos se mencionan claramente las características del adaptador de alimentación necesario para su funcionamiento. El uso de un adaptador distinto al mencionado puede producir daños físicos y/o daños al equipo conectado. El adaptador de alimentación debe operar con voltaje y frecuencia de la energía eléctrica domiciliar existente en el país o zona de instalación.

## Technical Support

If you have any questions regarding the product installation, please contact our Technical Support.

Toll free US/Canada: **1-866-845-3673**

Regional phone numbers available at [www.trendnet.com/support](http://www.trendnet.com/support)

## TRENDnet

20675 Manhattan Place  
Torrance, CA 90501  
USA

## Product Warranty Registration

Please take a moment to register your product online. Go to TRENDnet's website at: [www.trendnet.com/register](http://www.trendnet.com/register)