



Lühike paigaldusjuhend



TEG-S50g
TEG-S80g
H/W: V1

Eesti	1
1. Enne alustamist	1
2. Riistvara paigaldamine	3
3. LED'id	4
Tehniline Spetsifikatsioon	5
Tõrkeotsing	7

1. Enne alustamist



Pakendi sisu

- TE100-S50g/TE100-S80g
- Mitmekeelne lühike paigaldusjuhend
- AC toiteplokk (7.5V DC, 1A)
- Kummijalad

Minimaalsed nõuded süsteemile

- Sissepaigaldatud võrgukaardiga arvuti
- CAT-5, CAT-5e või CAT-6 arvutivõrgu kaabel
- Alus peab kannatama vähemalt 1,5 kg switchi
- Toitepistik peab asuma vähemalt 1.82 meetri kaugusel switchist
- Kontrollige visuaalselt, et alalisvoolu toiteplokk on turvaliselt ühendatud toitepistikusse
- Veenduge, et switchi ümber oleks piisav soojuste hajumine ja ventilatsioon.
- Ärge asetage switchi peale raskeid esemeid

TE100-S50g

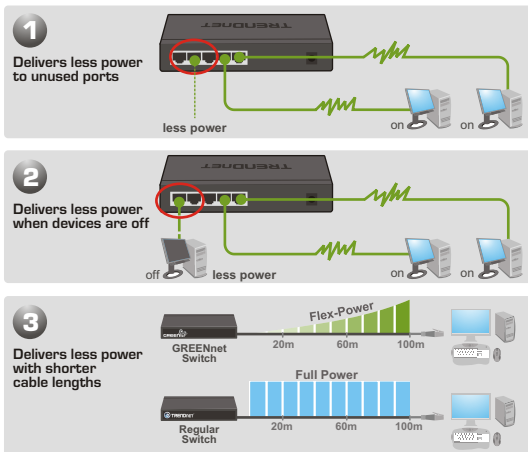

*Max power savings compared with standard TRENDnet switches.

TE100-S80g

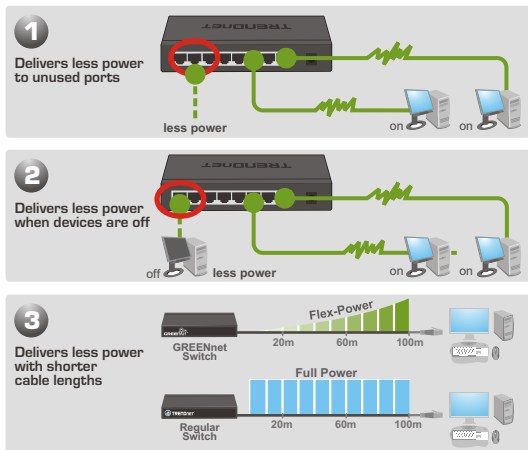

*Max power savings compared with standard TRENDnet switches.

2. Riistvara paigaldamine

1. Ühendage **alalisvoolu toiteplokk** TE100-S50g/TE100-S80g'ga ja seejärel ühendage seinakontakti.



2. Ühendage CAT-5, CAT-5e või CAT-6 RJ-45 võrgukaabel arvutist vabasse TE100-S50g/TE100-S80g Ethernet porti.



3. LED-tuled

Power

Roheline: Toide on sisselülitatud.
Ei põle: Toide on väljas.

Link/ACT

Roheline (Pidev): Ühendus teise seadmega.
Roheline (Vilkuv): Ühendus on aktiivne
Ei põle: Pordis ei ole avastatud midagi.



100Mbps

Roheline: Ühendus pordis on 100 (Full/Half)
Ei põle: Ühendus pordis on 10 (Full/Half)
või pordis ei avastatud midagi.

Traadivaba seadistamine on lõppenud.

Teie seadmete registreerimine

Et kindlustada teid parima teeninduse ja toega, palun leidke moment, et registreerida teie toode OnLines - www.Trendnet.com/register
Täname, et te valisite TRENDnet'i.

Hardware	
Standard	IEEE 802.3 10BASE-T IEEE 802.3u 100BASE-TX IEEE 802.3x Flow Control
Network Media	Ethernet: 2-Pair UTP/STP CAT-3, -4, -5 Fast Ethernet: 2-Pair UTP/STP CAT-5, -5e, -6
Data Transfer Rate	Ethernet: 10Mbps (half-duplex), 20Mbps (full-duplex) Fast Ethernet: 100Mbps (half-duplex), 200Mbps (full-duplex)
Protocol/Topology	CSMA/CD / Star
Interface	TE100-S50g: 5 x 10/100/1000 Auto-MDIX RJ-45 ports TE100-S80g: 8 x 10/100/1000 Auto-MDIX RJ-45 ports
Data RAM Buffer	TE100-S50g: 384Kbytes per device TE100-S80g: 768Kbytes per device
Packet Filtering/ Forwarding Rate	10Mbps Ethernet: 14,880pps (packet per second) 100Mbps Fast Ethernet: 148,800pps
MAC Address Learning	Automatic Update
Filtering Table	1K entries per device
Switch Fabric	TE100-S50g: 1Gbps Forwarding Capacity TE100-S80g: 1.6Gbps Forwarding Capacity
Power Consumption	TE100-S50g: 2.1W (max) TE100-S80g: 2.5W (max)
Diagnostic LEDs	Power, Link/ACT, 100Mbps
Power Adapter	7.5V DC, 1A External Power Adapter
Dimensions	TE100-S50g: 116 x 25 x 70 mm (4.57 x .98 x 2.76 in.) TE100-S80g: 136 x 25 x 70 mm (5.35 x .98 x 2.76 in.)
Weight	TE100-S50g: 225g TE100-S80g: 265g

Hardware

Temperature	Operating: 0° ~ 40° C (32° ~ 104° F) Storage: -10° ~ 70° C (14° ~ 158° F)
Humidity	Operating: 10% ~ 90% Storage: 5% ~ 90%
Certification	CE, FCC

K1: Kui ma olen ühendanud Switchi toiteploki seinapesasse, ei sütti LEDid.

V1: Kontrollige ühendust TE100-S50g/TE100-S80g toiteploki ja vooluallikaga. Samuti kontrollige, et seinapesas oleks voolu.

K2: Kui ma ühendan oma arvuti Switchi pordiga, siis LINK/ACT LED süttib, kuid 100Mbps LED jääb kustunuks.

V2: Kui 100Mbps LED ei sütti, siis arvuti ühenduse kiirus on 10Mbps.

K3: Kui ma olen ühendanud oma PC switchiga, ei saa ma jagada oma faile.

V3: Esiteks, vaadake switchil LEDe. Veenduge, et Link / ACT LED põlevad. Teiseks, kontrollige võrgu kaablit. Minimaalne kaabli pikkus on 1,5 meetrit ja pikim kaabel on 100 meetrit. Kolmandaks blokeeri tarkvara tulemüüri programm. Neljandaks, veenduge, et Teil on lubatud failide jagamine. Täiendava informatsiooni saamiseks pöörduge, palun, oma süsteemadministraatori poole.

K4: Pärast seda, kui ma olen ühendanud arvutid switchiga, saan ma Internetiühendust ainult ühest arvutist

V4: Switch ei ole loodud jagama Internetti mitmele arvutile korraga. Selleks vajate Internetiruutereid nagu TW100-S4W1CA.

K5: Kus asub switchil üleslingi port?

V5: Kuna switchil on kõik pordid Auto-MDIX, siis saab kõiki porte kasutada üleslingi portidena.

Kui teil endiselt esineb probleeme või on teil küsimusi **TE100-S50g/TE100-S80g** kohta, võtke ühendust TRENDneti tehnilise toe osakonnaga.

Limited Warranty

TRENDnet warrants its products against defects in material and workmanship, under normal use and service, for the following lengths of time from the date of purchase.

TE100-S50g/TE100-S80g	5-Year Limited Warranty
------------------------------	--------------------------------

If a product does not operate as warranted above during the applicable warranty period, TRENDnet shall, at its option and expense, repair the defective product or deliver to customer an equivalent product to replace the defective item. All products that are replaced will become the property of TRENDnet. Replacement products may be new or reconditioned.

TRENDnet shall not be responsible for any software, firmware, information, or memory data of customer contained in, stored on, or integrated with any products returned to TRENDnet pursuant to any warranty.

There are no user serviceable parts inside the product. Do not remove or attempt to service the product through any unauthorized service center. This warranty is voided if (i) the product has been modified or repaired by any unauthorized service center, (ii) the product was subject to accident, abuse, or improper use (iii) the product was subject to conditions more severe than those specified in the manual.

Warranty service may be obtained by contacting TRENDnet office within the applicable warranty period for a Return Material Authorization (RMA) number, accompanied by a copy of the dated proof of the purchase. Products returned to TRENDnet must be pre-authorized by TRENDnet with RMA number marked on the outside of the package, and sent prepaid, insured and packaged appropriately for safe shipment.

WARRANTIES EXCLUSIVE: IF THE TRENDNET PRODUCT DOES NOT OPERATE AS WARRANTED ABOVE, THE CUSTOMER'S SOLE REMEDY SHALL BE, AT TRENDNET'S OPTION, REPAIR OR REPLACEMENT. THE FOREGOING WARRANTIES AND REMEDIES ARE EXCLUSIVE AND ARE IN LIEU OF ALL OTHER WARRANTIES, EXPRESSED OR IMPLIED, EITHER IN FACT OR BY OPERATION OF LAW, STATUTORY OR OTHERWISE, INCLUDING WARRANTIES OF MERCHANTABILITY AND FITNESS FOR A PARTICULAR PURPOSE. TRENDNET NEITHER ASSUMES NOR AUTHORIZES ANY OTHER PERSON TO ASSUME FOR IT ANY OTHER LIABILITY IN CONNECTION WITH THE SALE, INSTALLATION, MAINTENANCE OR USE OF TRENDNET'S PRODUCTS.

TRENDNET SHALL NOT BE LIABLE UNDER THIS WARRANTY IF ITS TESTING AND EXAMINATION DISCLOSE THAT THE ALLEGED DEFECT IN THE PRODUCT DOES NOT EXIST OR WAS CAUSED BY CUSTOMER'S OR ANY THIRD PERSON'S MISUSE, NEGLIGENCE, IMPROPER INSTALLATION OR TESTING, UNAUTHORIZED ATTEMPTS TO REPAIR OR MODIFY, OR ANY OTHER CAUSE BEYOND THE RANGE OF THE INTENDED USE, OR BY ACCIDENT, FIRE, LIGHTNING, OR OTHER HAZARD.

LIMITATION OF LIABILITY: TO THE FULL EXTENT ALLOWED BY LAW TRENDNET ALSO EXCLUDES FOR ITSELF AND ITS SUPPLIERS ANY LIABILITY, WHETHER BASED IN CONTRACT OR TORT (INCLUDING NEGLIGENCE), FOR INCIDENTAL, CONSEQUENTIAL, INDIRECT, SPECIAL, OR PUNITIVE DAMAGES OF ANY KIND, OR FOR LOSS OF REVENUE OR PROFITS, LOSS OF BUSINESS, LOSS OF INFORMATION OR DATA, OR OTHER FINANCIAL LOSS ARISING OUT OF OR IN CONNECTION WITH THE SALE, INSTALLATION, MAINTENANCE, USE, PERFORMANCE, FAILURE, OR INTERRUPTION OF THE POSSIBILITY OF SUCH DAMAGES, AND LIMITS ITS LIABILITY TO REPAIR, REPLACEMENT, OR REFUND OF THE PURCHASE PRICE PAID, AT TRENDNET'S OPTION. THIS DISCLAIMER OF LIABILITY FOR DAMAGES WILL NOT BE AFFECTED IF ANY REMEDY PROVIDED HEREIN SHALL FAIL OF ITS ESSENTIAL PURPOSE.

Governing Law: This Limited Warranty shall be governed by the laws of the state of California.

Note: AC/DC Power Adapter, Cooling Fan, Cables and Power Supply carry a 1-Year Warranty

Sertifikaadid:

Antud seade on testitud ja leitud vastavaks FCC ja CE seadustega.

1. Antud seade ei põhjusta kahjulikke häireid.
2. Antud seade peab vastu võtma kõik saadud häired, sealhulgas häired, mis võivad põhjustada soovimatut tööd.



Elektri- ja elektroonikatoodete jäätmeid ei tohi ära visata koos olmejäätkeidega. Abivahendite olemasolu korral palume ümber töötlemiseks sorteerida. Küsi nõu jäätmete ümber töötlemise kohta oma kohalikul jaemüüjalt.



MÄRKUS: TOOTJA EI VASTUTA ÜHEGI TV VÕI RAADIO HÄIRETE EEST, MIS ON PÕHJUSTATUD ANTUD SEADME LUBAMATUST ÜMBEREHITAMISEST. IGASUGUNE ÜMBERMODIFITSEERIMINE TÜHISTAB AUTORIVASTUTUSE ANTUD SEADMELE.



TRENDnet®

Product Warranty Registration

Please take a moment to register your product online.
Go to TRENDnet's website at <http://www.trendnet.com/register>

TRENDnet®

20675 Manhattan Place
Torrance, CA 90501
USA